



Province of British Columbia

Water Sustainability Act

CONDITIONAL WATER LICENCE

The owner(s) of the land to which this licence is/are appurtenant are hereby authorized to use water as follows:

- a) The stream on which the rights are granted is Fountain Creek.
- b) The point of diversion is located as shown on the attached plan.
- c) The date from which this licence shall have precedence is May 31, 2016.
- d) The purpose for which this licence is issued is domestic.
- e) The maximum quantity of water which may be diverted for domestic is 4000 litres per day.
- f) The period of the year during which the water may be used is May 1 to October 31.
- g) The land upon which the water is to be used and to which this licence is appurtenant is Block C of District Lot 2969 Lillooet District.
- h) The authorized works are diversion structure, screened intake, pump, pipe, tank which shall be located approximately as shown on the attached plan.
- i) The construction of the said works has been completed and the water is being beneficially used. The licensee shall continue to make regular beneficial use of the water in a manner authorized herein.
- j) This licence is issued under the *Water Sustainability Act* (the Act). The exercise of rights under the licence is subject to the Act and its regulations, the terms and conditions of the licence, orders under the Act and the rights of licensees whose rights have precedence on the stream or on an aquifer. The licensee must comply with all such requirements, as well as the provisions of all other applicable enactments. In exercising rights under the licence, the licensee must exercise reasonable care to avoid damaging land, works, trees or other property, and must make full compensation to the owners for damage or loss resulting from construction, maintenance, use, operation or failure of the works.
- k) This licence authorizes the use of water for domestic purpose in two dwelling(s) located approximately as shown on the attached plan.

- l) The diversion of water authorized under this licence may be restricted or prohibited at any time by an Order in writing under the *Water Sustainability Act*, in order to maintain a minimum flow in a stream for the preservation of fish or for maintaining the health of aquatic ecosystems.

A handwritten signature in black ink, appearing to read 'Patrick Farmer', with a long horizontal flourish extending to the right.

Patrick Farmer
Assistant Water Manager

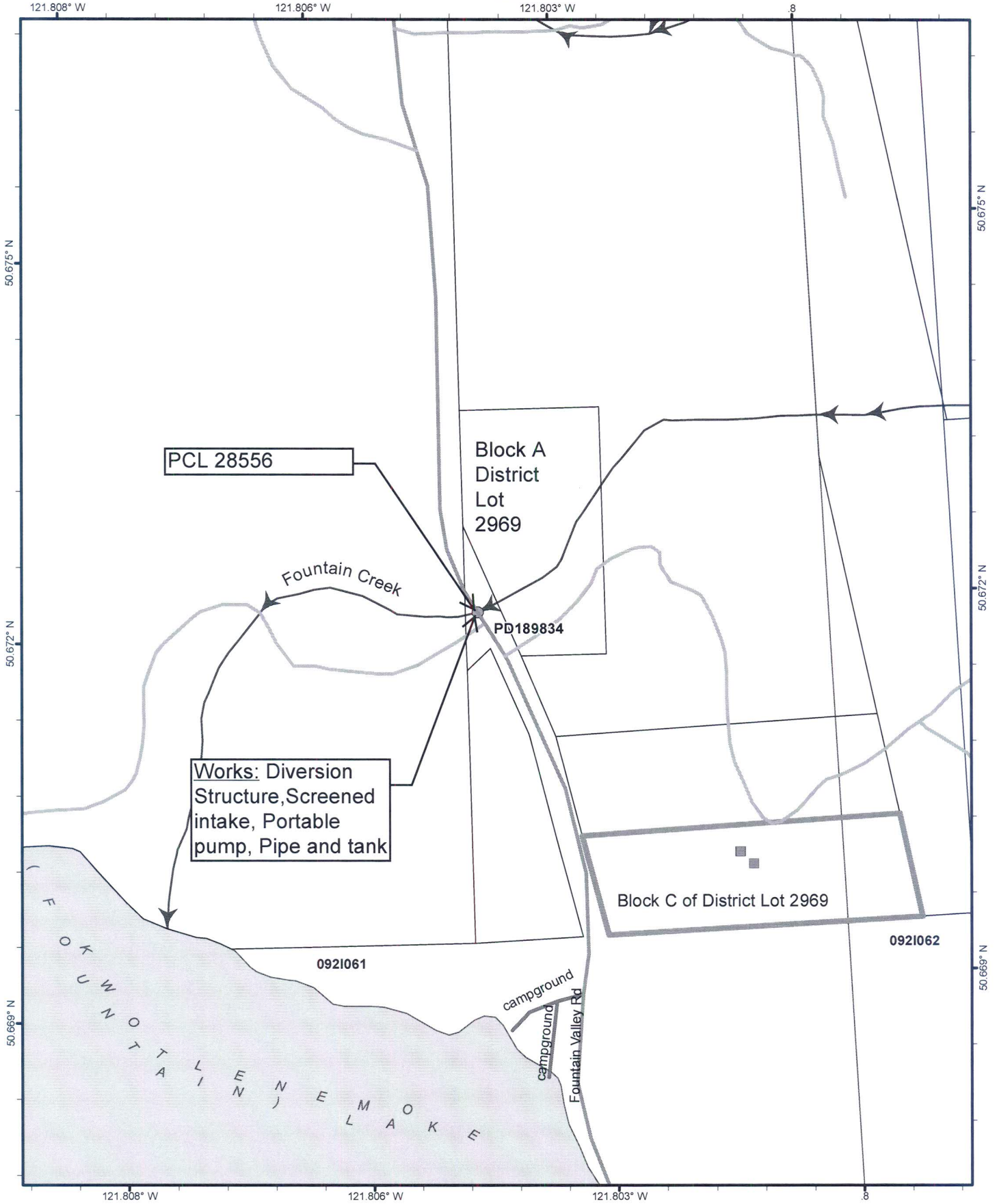

Scale: 1:4,000



Point of Diversion: 
Works  Dwelling

Direction of Flow: 

The boundaries of the land to which this licence is appurtenant are shown thus: 

Mapsheet : 0921061

Land District : LILLOOET DISTRICT

Water District: Ashcroft

Precinct: Bridge River

Signature: 

Date: December 5/16

Licence: C133381
File: 3005779
PCL 28556

