



Province of British Columbia

Water Sustainability Act

FINAL WATER LICENCE

The owners of the land to which this licence is appurtenant are hereby authorized to divert and use water as follows:

- a) The stream on which the rights are granted is Kerby Brook.
- b) The point of diversion is located as shown on the attached plan.
- c) The date from which this licence shall have precedence is June 10, 1944.
- d) The purpose for which this licence is issued is Livestock and Animal: Stock Watering.
- e) The maximum quantity of water which may be diverted for domestic is 1.137 m³/day (250 gallons per day)
- f) The period of the year during which the water may be used is January 1 to December 31.
- g) The land upon which the water is to be used and to which this licence is appurtenant is That Part of District Lot 328 Shown on Plan B1759; Similkameen Division Yale District Except Plan 13756.
- h) The authorized works are pipe and trough which are located approximately as shown on the attached plan.
- i) The construction of the said works has been completed and the water is being beneficially used. The licensee shall continue to make regular beneficial use of the water in a manner authorized herein.
- j) The industrial livestock and animal purpose authorized by this licence is for use outside the wetted perimeter of the source in a trough located approximately as shown on the attached plan.
- k) This licence is issued under the *Water Sustainability Act* (the Act). The exercise of rights under the licence is subject to the Act and its regulations, the terms and conditions of the licence, orders under the Act and the rights of licensees whose rights have precedence on the stream or on an aquifer. The licensee must comply with all such requirements, as well as the provisions of all other applicable enactments. In exercising rights under the licence, the

licensee must exercise reasonable care to avoid damaging land, works, trees or other property, and must make full compensation to the owners for damage or loss resulting from construction, maintenance, use, operation or failure of the works.

A handwritten signature in black ink that reads "Ray Reilly". The script is cursive and somewhat informal.

Ray Reilly
Assistant Water Manager

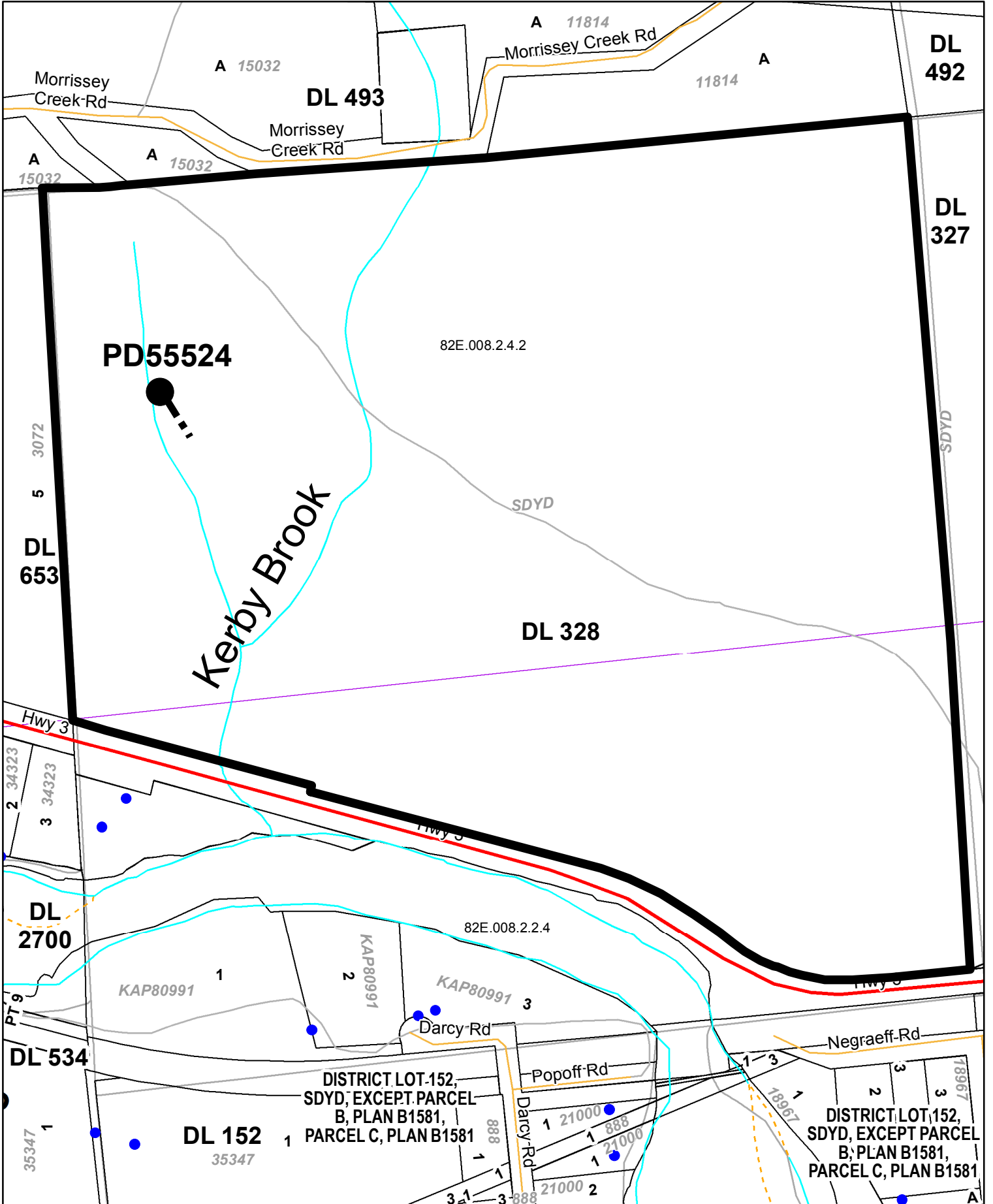

Water District: Grand Forks

Precinct: Cascade

Land District: SDYD

Map Number: 82E.008.2.4.2

Scale: 1:4,500

LEGEND:

- Point of Diversion: ●
- Pipe: - - - - -
- Permit Over Crown Land: 

The boundaries of this land to which this licence is appurtenant are shown thus: 

Signature: *Ron Reilly*

Date: 05/10/2016

Licence: F133402

File: 0150839



ORDER UNDER THE WATER SUSTAINABILITY ACT
SECTION 26

File No. 0150839

In the matter of Final Water Licence 133402, which authorizes the diversion of water from Kerby Brook for Livestock and Animal purpose within that part of District Lot 328 shown on Plan B1759, Similkameen Division Yale District, except Plan 13756 of which 1.137 m³/day may be diverted; and,

Having determined that administrative errors occurred in the issuing of Final Water Licence 133402 on 5 October 2016, and being satisfied that no person's rights will be injuriously affected I hereby amend clauses (d) and (e) of the said licence to read as follows:

(d) The purpose for which this licence is issued is Livestock and Animal.

(e) The maximum quantity of water which may be diverted for Livestock and Animal is 414.83 m³/year (91,250 gallons per year) or 1.137 m³/day (250 gallons per day).

Dated at Penticton, B.C. this 20th day of October, 2016

A handwritten signature in black ink that reads "Ron Reilly". The signature is written in a cursive, slightly slanted style.

Assistant Water Manager