



# Province of British Columbia

## *Water Sustainability Act*

### **CONDITIONAL WATER LICENCE**

The Province of British Columbia as represented by Freshwater Fisheries Society of BC are hereby authorized to divert and use water as follows:

- a) The stream on which the rights are granted is Dragon Lake.
- b) The point of diversion is located as shown on the attached plan.
- c) The date from which this licence shall have precedence is December 3, 2015.
- d) The purpose for which this licence is issued is conservation: use of water.
- e) The maximum quantity of water which may be diverted for conservation purpose is 221,356.8 cubic metres per year at a maximum withdrawal rate of 0.06309 cubic metres per second.
- f) The period of the year during which the water may be used is March 1 to June 30.
- g) The land upon which the water is to be used and to which this licence is appurtenant is Lot 1, District Lot 715, Plan 31660, Cariboo Land District.
- h) The authorized works are pump, pipe, screened intake which shall be located approximately as shown on the attached plan.
- i) The construction of the said works shall be completed and the water shall be beneficially used prior to December 31, 2019. Thereafter, the licensee shall continue to make regular beneficial use of the water in the manner authorized herein.

- j) This licence is issued under the *Water Sustainability Act* (the Act). The exercise of rights under the licence is subject to the Act and its regulations, the terms and conditions of the licence, orders under the Act and the rights of licensees whose rights have precedence on the stream or on an aquifer. The licensee must comply with all such requirements, as well as the provisions of all other applicable enactments. In exercising rights under the licence, the licensee must exercise reasonable care to avoid damaging land, works, trees or other property, and must make full compensation to the owners for damage or loss resulting from construction, maintenance, use, operation or failure of the works.



David J. Weir  
Water Manager

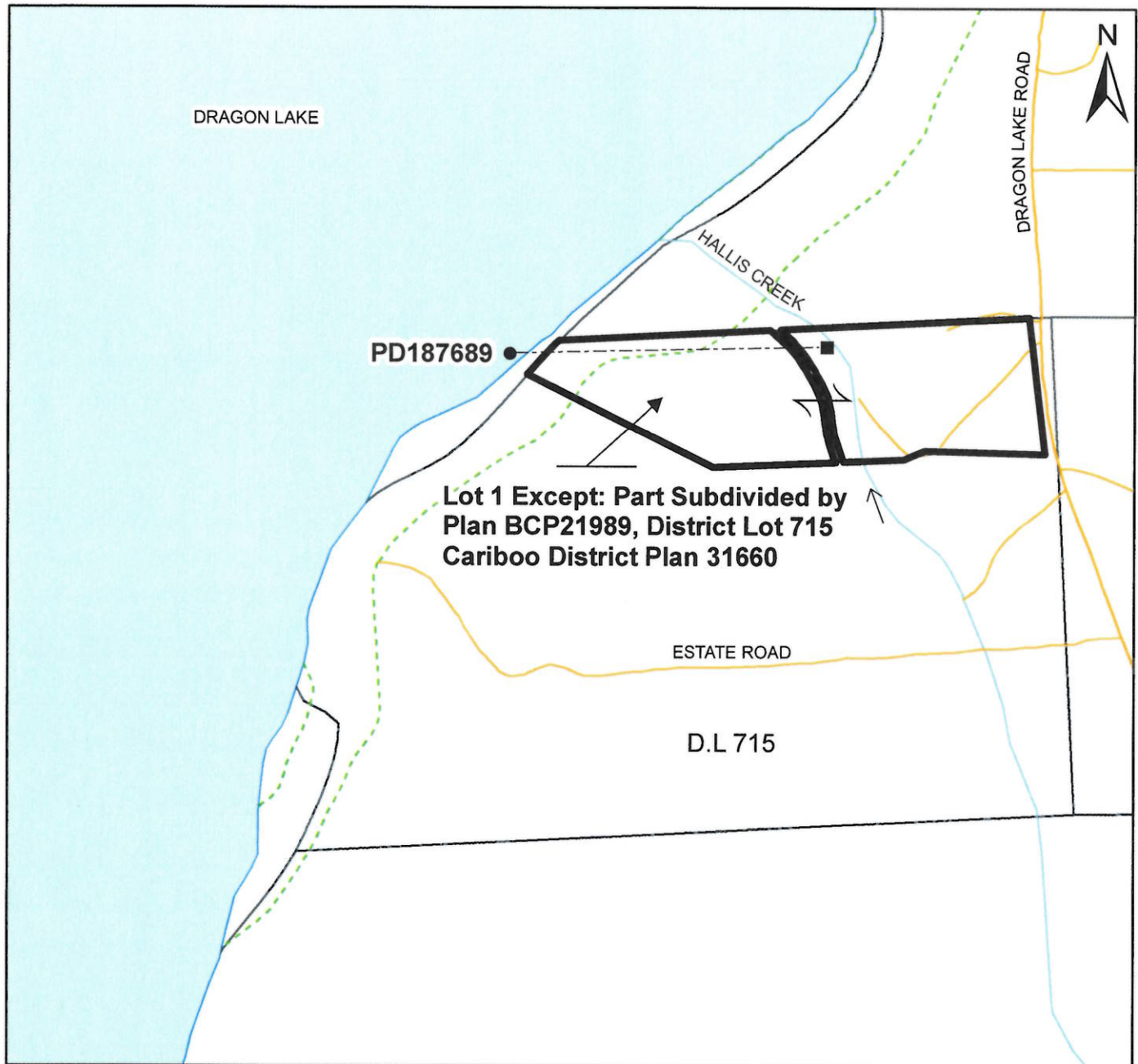

### Legend

Scale: 1:5,000

Mapsheet: 93.B.098

Pipe: -----

Point of Diversion: ●

Dragon Creek  
Hatchery Site: ■

The boundaries of the land to  
which this licence is appurtenant  
are shown thus: **—————**

**Water District:** QUESNEL

**Precinct:** COTTONWOOD

**Land District:** CARIBOO

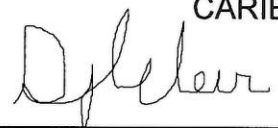
Signature: 

Date: October 19th 2016

CL: C133444

File: 5002545

