



# Province of British Columbia

## *Water Sustainability Act*

### CONDITIONAL WATER LICENCE

The owner(s) of the land to which this licence is appurtenant are hereby authorized to divert and use water as follows:

- a) The stream on which the rights are granted is Deka Lake.
- b) The point of diversion is located as shown on the attached plan.
- c) The date from which this licence shall have precedence is July 12, 2016.
- d) The purpose for which this licence is issued is domestic.
- e) The maximum quantity of water which may be diverted for domestic is 2.273 cubic meters per day.
- f) The period of the year during which the water may be used is January 1 to December 31.
- g) The land upon which the water is to be used and to which this licence is appurtenant is Lot 14 District Lot 3721 Lillooet District Plan 21280.
- h) The authorized works are pump, pipe and screened intake which shall be located approximately as shown on the attached plan.
- i) The construction of the said works shall be completed and the water shall be beneficially used prior to December 31, 2019. Thereafter, the licensee shall continue to make regular beneficial use of the water in the manner authorized herein.
- j) This licence authorizes the use of water for domestic purpose in one dwelling located approximately as shown on the attached plan.

- k) This licence is issued under the *Water Sustainability Act* (the Act). The exercise of rights under the licence is subject to the Act and its regulations, the terms and conditions of the licence, orders under the Act and the rights of licensees whose rights have precedence on the stream or on an aquifer. The licensee must comply with all such requirements, as well as the provisions of all other applicable enactments. In exercising rights under the licence, the licensee must exercise reasonable care to avoid damaging land, works, trees or other property, and must make full compensation to the owners for damage or loss resulting from construction, maintenance, use, operation or failure of the works.



David J. Weir  
Water Manager

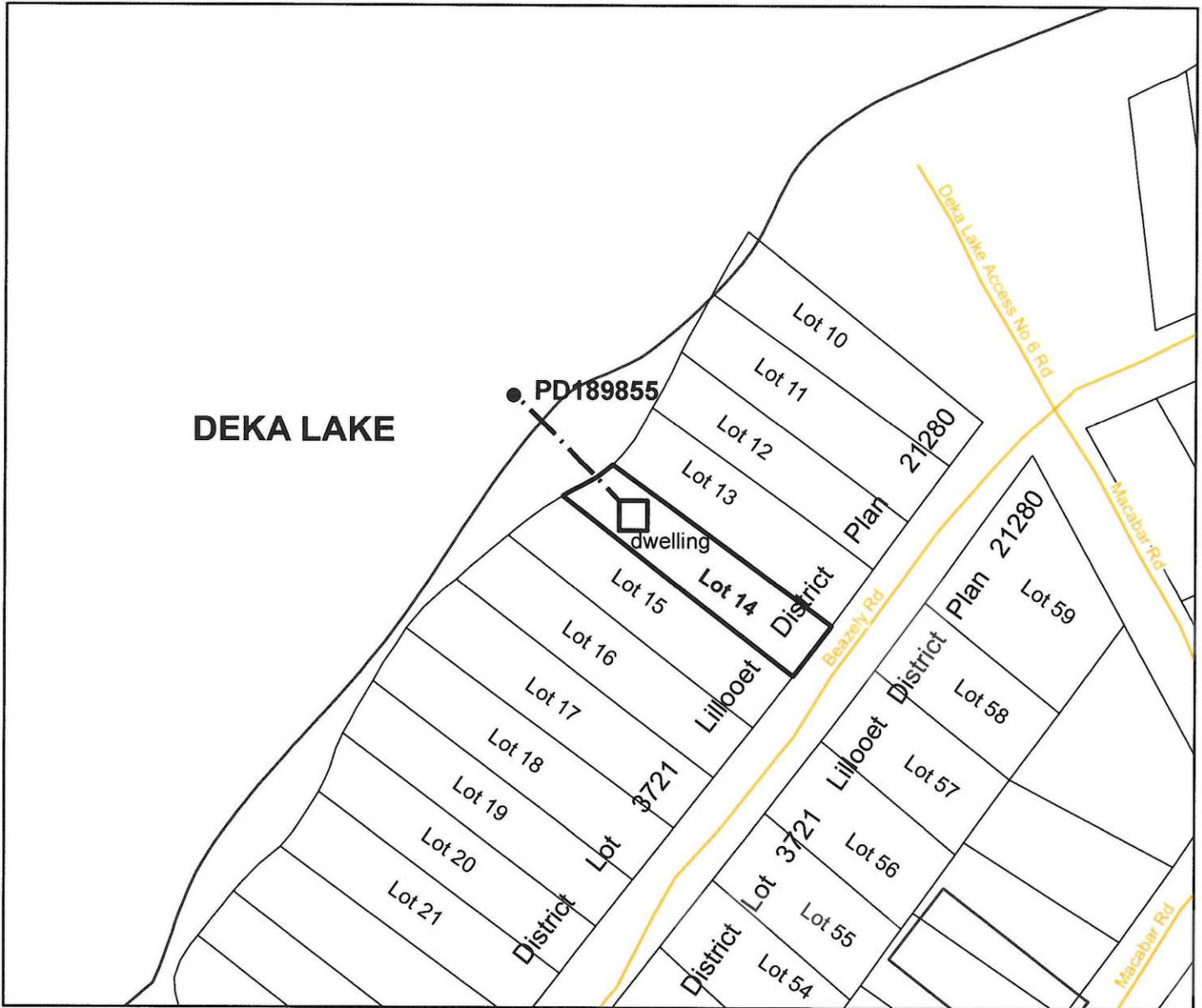

**Water District:** CARIBOO  
**Precinct:** CLEARWATER  
**Land District:** LILLOOET

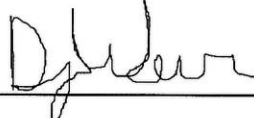
Signature: 

Date: October 13th 2016

Scale: 1:1,000  
 Mapsheet: 92P.066  
 Pipe: -----  
 Point of Diversion: ●  
 Dwelling:

CL: C133446  
 File: 5002654  
 PCL: 28528

The boundaries of the land to which this licence is appurtenant are shown thus: —————