



Province of British Columbia

Water Sustainability Act

CONDITIONAL WATER LICENCE

The owner(s) of the land to which this licence is appurtenant is/are hereby authorized to divert and use water as follows:

- a) The stream on which the rights are granted is Bonnevier Creek.
- b) The point of diversion is located as shown on the attached plan.
- c) The date from which this licence shall have precedence is June 11, 1981.
- d) The purpose for which this licence is issued is commercial enterprise: enterprise.
- e) The maximum quantity of water which may be diverted for commercial enterprise: enterprise is 25.00350 cubic metres per day.
- f) The period of the year during which the water may be used is the whole year.
- g) The land upon which the water is to be used and to which this licence is appurtenant is Lot 3 of District Lot 902 Yale Division Yale District Plan EPP55773
- h) The authorized works are diversion structure, screened intake, pipe and tank which shall be located approximately as shown on the attached plan.
- i) The construction of the said works has been completed and the water is being beneficially used. The licensee shall continue to make regular beneficial use of the water in a manner authorized herein.
- j) This licence is issued under the *Water Sustainability Act* (the Act). The exercise of rights under the licence is subject to the Act and its regulations, the terms and conditions of the licence, orders under the Act and the rights of licensees whose rights have precedence on the stream or on an aquifer. The licensee must comply with all such requirements, as well as the provisions of all other applicable enactments. In exercising rights under the licence, the licensee must exercise reasonable care to avoid damaging land, works, trees or other property, and must make full compensation to the owners for damage or loss resulting from construction, maintenance, use, operation or failure of the works.

- k) The licensee shall install a flow measuring device to the satisfaction of an Engineer under the *Water Sustainability Act*.
- l) The licensee shall retain flow meter records for inspection upon request by an Engineer under the *Water Sustainability Act*.
- m) This Licence is issued in substitution of Conditional Water Licence C111007.



Patrick Farmer
Assistant Water Manager

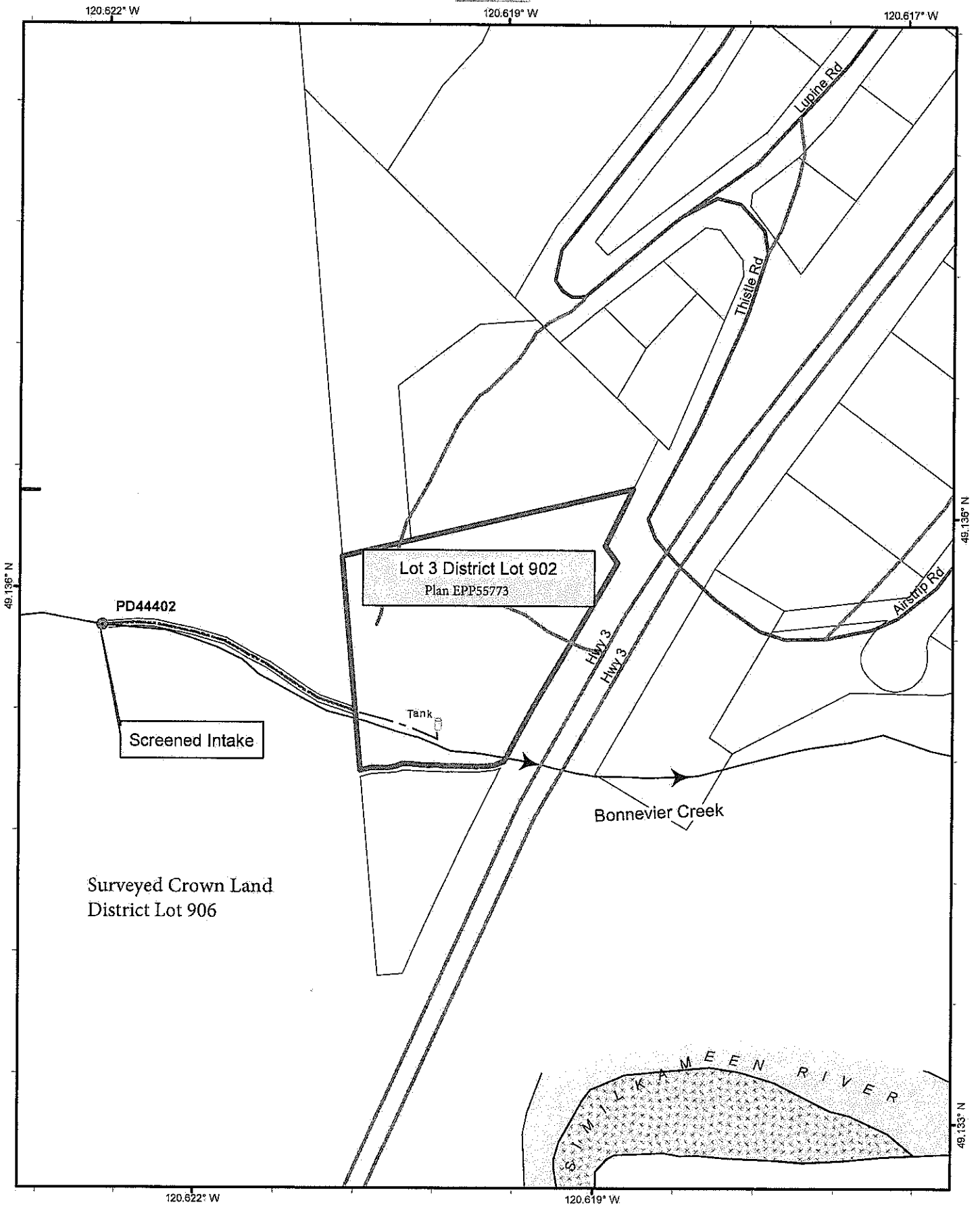

Scale: 1:2,500

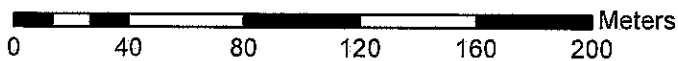

Point of Diversion:
Works points



Pipeline:



Direction of Flow:

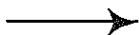

Permit Over Crown Land:

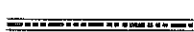

The boundaries of the land
to which this licence is appurtenant
are shown thus:



Mapsheet : 092H017

Land District : YDYD

Water District: Princeton

Precinct: Princeton

Signature:

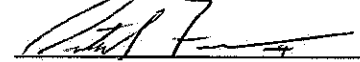

Date:

October 20, 2016



Licence: C133466 for C111007

File: 0368804

PCL#: 28531