



Province of British Columbia

Water Sustainability Act

CONDITIONAL WATER LICENCE

The owner of the Mineral Tenure Number: PL 1044033 to which this licence is appurtenant is hereby authorized to divert and use water as follows:

- a) The stream on which the rights are granted is Grouse Creek.
- b) The point of diversion is located as shown on the attached plan.
- c) The date from which this licence shall have precedence is May 4, 2016.
- d) The purpose for which this licence is issued is mining: placer.
- e) The maximum quantity of water which may be diverted for mining: placer is 114,048 cubic metres per year at a maximum withdrawal rate of 0.0100 cubic metre per second.
- f) The period of the year during which the water may be used is June 1 to October 31.
- g) The mine upon which the water is to be used and to which this licence is appurtenant is the mining project of the licensee within Mineral Tenure Number: PL 1044033.
- h) The authorized works are pump, screened intake, wash plant, settling pond, pipe which shall be located within Mineral Tenure Number: PL 1044033 , Cariboo Mining District.
- i) The construction of the said works shall be completed and the water shall be beneficially used prior to December 31, 2019. Thereafter, the licensee shall continue to make regular beneficial use of the water in the manner authorized herein.
- j) This licence is issued under the *Water Sustainability Act* (the Act). The exercise of rights under the licence is subject to the Act and its regulations, the terms and conditions of the licence, orders under the Act and the rights of licensees whose rights have precedence on the stream or on an aquifer. The licensee must comply with all such requirements, as well as the provisions of all other applicable enactments. In exercising rights under the licence, the licensee must exercise reasonable care to avoid damaging land, works, trees or other property, and must make full compensation to the owners for damage or loss resulting from construction, maintenance, use, operation or failure of the works.

- k) The diversion of water authorized under this licence may be restricted or prohibited at any time by an Order in writing under the *Water Sustainability Act*, in order to maintain a minimum flow in a stream for the preservation of fish.
- l) This licence is valid only as long as Mineral Tenure Number: PL 1044033 is in good standing.



David J. Weir
Water Manager

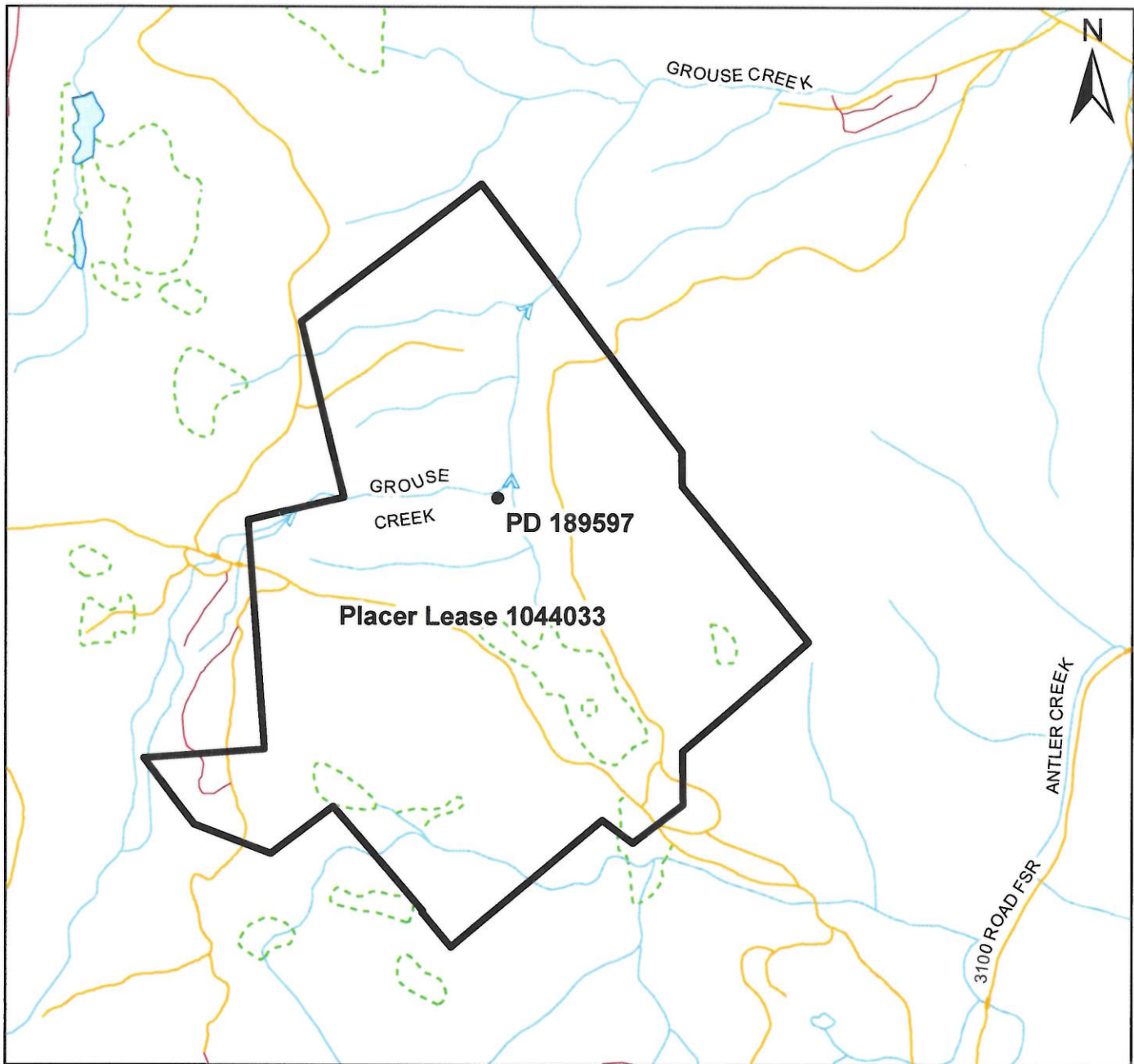

Legend

Scale: 1:10,000

Mapsheet: 93H003

Point of Diversion: ●

The boundaries of the land to
which this licence is appurtenant
are shown thus: 

Water District: QUESNEL

Precinct: COTTONWOOD

Land District: CARIBOO

Signature: 

Date: November 9th 2016

CL: 133481

File: 5002628