



Province of British Columbia

Water Sustainability Act

CONDITIONAL WATER LICENCE

The owners of the land to which this licence is appurtenant are hereby authorized to store water as follows:

- a) The stream on which the rights are granted is Little Bridge Creek and the reservoir is Exeter Lake and Little Bridge Creek.
- b) The storage site is located as shown on the attached plan.
- c) The date from which this licence shall have precedence is March 1st, 1984.
- d) The purpose for which this licence is issued is set out in Conditional Water Licence 133517.
- e) The maximum quantity of water which may be diverted for storage is 209,700 cubic metres (170 acre feet) per annum.
- f) The period of the year during which the water may be used is from October 1st to June 15th.
- g) The land upon which the water is to be used and to which this licence is appurtenant is set out in Conditional Water Licence 133517.
- h) The authorized works are a dam which shall be located approximately as shown on the attached plan.
- i) The construction of the said works has been completed and the water is being used. The licensee shall continue to make regular beneficial use of the water in a manner authorized herein.
- j) The dam authorized under clause (h) is subject to the Dam Safety Regulations and shall be designed, constructed and maintained to the satisfaction of a Dam Safety Officer under the Water Act and in accordance with the Canadian Dam Association Guidelines.
- k) Final construction drawings, Operation, Maintenance and Surveillance Manual and Emergency Preparedness Plan must be submitted to the Dam Safety Officer.

- l) This licence is issued under the *Water Sustainability Act* (the Act). The exercise of rights under the licence is subject to the Act and its regulations, the terms and conditions of the licence, orders under the Act and the rights of licensees whose rights have precedence on the stream. The licensee must comply with all such requirements, as well as the provisions of all other applicable enactments. In exercising rights under the licence, the licensee must exercise reasonable care to avoid damaging land, works, trees or other property, and must make full compensation to the owners for damage or loss resulting from construction, maintenance, use, operation or failure of the works.

- m) This Licence is issued in substitution of Conditional Water Licence 131915, in part.



David J. Weir
Water Manager

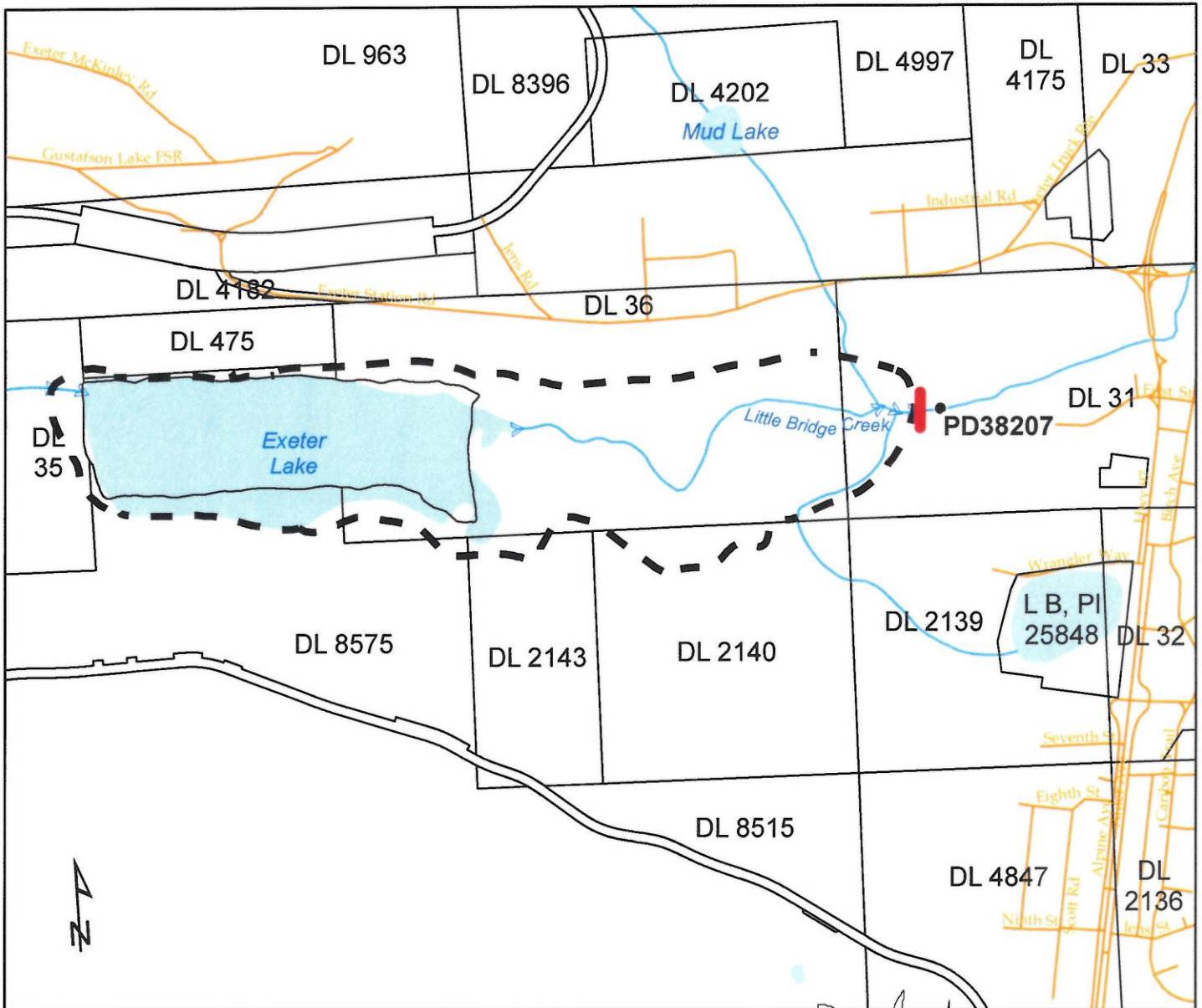





Water District: CARIBOO
 Precinct: CLEARWATER
 Land District: LILLOOET DISTRICT

Signature: *D. P. [Signature]*

Date: December 12th 2016

Scale: 1:20,000
 Mapsheet: 92P.064

Dam: 
 Point of Diversion: 
 Downstream Direction: 
 Flooding Limit: 

C.L. 133520 for C.L. 131915, in part

File: 5002426

For diversion see C.L. 133517

