



Province of British Columbia

Water Sustainability Act

CONDITIONAL WATER LICENCE

The owners of the land to which this licence is appurtenant are hereby authorized to divert and use water as follows:

- a) The aquifer on which the rights are granted is Aquifer 578.
- b) The point of well diversion is located as shown on the attached plan.
- c) The date from which this licence shall have precedence is June 1, 2015.
- d) The purpose for which this licence is issued is livestock & animal use (dairy cattle).
- e) The maximum quantity of water which may be diverted for livestock & animal use is 6,570 cubic metres/year, at a rate not to exceed 36 cubic metres per day.
- f) The period of the year during which the water may be used is the whole year.
- g) The land upon which the water is to be used and to which this licence is appurtenant is Part NW 1/4 of Section 4 Township 4 Range 5 Coast District, except Plans PRP14394, PRP14992, and PRP 41613.
- h) The authorized works are an excavated well, pressure tank, pump and pipe.
- i) The construction of the said works has been completed and the water is being beneficially used. The licensee shall continue to make regular beneficial use of the water in a manner authorized herein.
- j) The works authorized under clause (h) hereof shall be maintained to the satisfaction of a Water Manager under the *Water Sustainability Act*.
- k) The licensee shall ensure that the works can accommodate a flow metering device to record the rate and volume of water diverted under this license, should this request be made at a future date by a Water Manager under the *Water Sustainability Act*.
- l) The exercise of rights under this licence is subject to the *Water Sustainability Act* and its regulations, the terms and conditions of the licence, Orders under the *Water Sustainability Act* and the rights of licensees whose rights have precedence on the stream or on the aquifer.

The licensee must comply with all such requirements, as well as the provisions of all other applicable enactments.

A handwritten signature in black ink, appearing to be 'S. Staplin', with a long horizontal stroke extending to the right.

S. Staplin
Assistant Water Manager

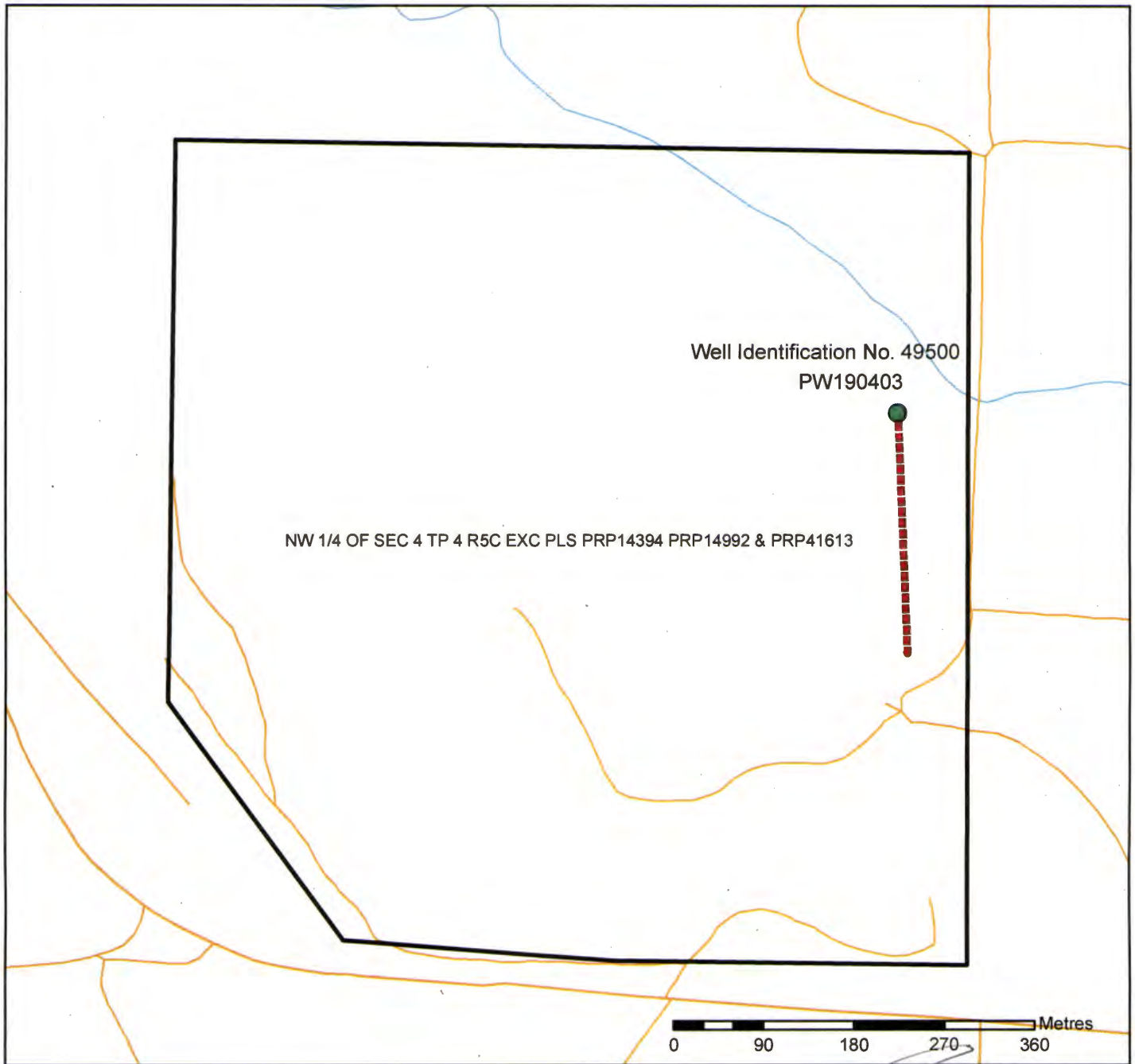

Water District: Hazelton
Precinct: Smithers
Land District: Coast

LEGEND:

Point of Well Diversion: ●
Approximate Works: ■■■■■■
Stream: ————
Road: ————
Map Number: 093L075
Scale: 1:6,000

The boundaries of the land to which this licence is appurtenant are shown thus: ————

Signature: _____

Date: DEC 20 2016

Water Licence #: 500010

File: 20002158