



THE GOVERNMENT OF
THE PROVINCE OF BRITISH COLUMBIA.

DEPARTMENT OF LANDS.

Permit under the "Water Act," ~~1914~~ authorizing
Entry upon Crown Lands.

WHEREAS JOHN CHARLES BIRCH

whose address is Moha, B.C.

being the holder of Conditional Licence 3735

has petitioned the Minister of Lands for a permit to enter upon the unoccupied
Crown lands hereinafter described, and in respect thereof has complied with the requirements of the
"Water Act," ~~1914~~, and the rules and regulations thereunder:

Now, therefore, in pursuance of the "Water Act," ~~1914~~, this permit is issued authorizing the holder
of the above-mentioned licence (hereinafter called the "licensee") to enter upon, use, and occupy a
right-of-way of the following dimensions: Length, 1.500 feet; width, 15 feet;
area, 0.51 acres, across the unoccupied Crown lands known as
Lot 3319, and approximately shown in Exhibit "A" hereto, subject to the following terms
and conditions:—

1. The easement granted by this permit is appurtenant to Lot 3101, Gp. 1, Lillooet Dist.

2. The period during which the authority granted under this permit may be exercised, unless sooner
terminated as herein provided, is 20 years, subject, however, to renewal at the end of the
said term under the laws and regulations then in force.

3. There shall be payable under this permit on the date hereof and annually hereafter, at the office
of the Comptroller of Water Rights at the City of Victoria, whether demanded or not, an annual rental
of such amount as may be fixed by or under any rules and regulations respecting the entry upon, use of,
or occupation of Crown lands made from time to time by His Honour the Lieutenant-Governor in
Council under authority lawfully vested in him. The said annual rental until lawfully altered shall
be \$ 1.00, and unless the said annual rental is paid punctually as aforesaid this
permit may be cancelled without notice.

W.R.B. No. 1020-500-8-22-8498
File No. 106-4-16

Bridge Rev. B

*Abandoned
257 25 Nov. 1966*

The License covenants that no Chinese or Japanese shall be employed on any work carried on on the demised premises.

PROVIDED also that nothing in this clause contained shall affect any treaty now existing between Great Britain and any other country or countries, or any treaty which may hereafter be entered into between Great Britain and any other country or countries, and which may be hereafter sanctioned and declared to have the force of law in Canada.

4. This permit gives the licensee the right to cut or remove from said lands such timber only as is necessary for the construction of the said works thereon under said licence and subject to the payment by way of stumpage at the rate of \$.....1.00.....per one thousand feet board measure and royalty as provided for in the "Timber Royalty Act," the same to be determined, paid, and collected according to the provisions of the "Forest Act" relating to the collection of royalty.

5. There is reserved to the Crown the right to grant to other persons permits to enter upon, use, and occupy the lands over which the said right-of-way is granted hereunder without payment to the licensee, or his successors in title, of compensation, save for actual damage.

6. In the event of a dispute arising at any time during the term of this permit between the licensee and the registered owner of the lands immediately adjacent to the said right-of-way respecting the exact location of the said right-of-way, the licensee shall at his own expense have the said right-of-way surveyed by a duly qualified land surveyor, and shall likewise file in the Lands Department at Victoria, B.C., a map or plan showing the said right-of-way as surveyed.

7. This permit and the rights granted hereunder shall be subject always to compliance by the licensee with all the terms and conditions of the said licence, and if the said licence should at any time lapse, expire, be cancelled, abandoned, or declared null and void, this permit shall, *ipso facto*, become void and of no effect and all rights granted hereunder shall cease and determine.

8. This permit and the rights granted hereunder shall be subject always to compliance by the licensee with the terms and conditions herein contained, and if the licensee fail at any time to fulfil, keep, and observe the said terms and conditions, or any of them, it shall be lawful for the Minister of Lands of the Province of British Columbia, his agent or servant, on behalf of the Crown, upon thirty days' notice to that effect, absolutely to cancel all the rights granted hereunder; and thereupon this permit and the said rights shall cease, determine, and be of no effect without any other proceeding whatever.

9. This permit shall have the effect only of a permit issued under section ⁵⁰~~98~~ of the said "Water Act," ~~1914~~ and the easements, rights, and privileges of the licensee in respect of the said lands thereunder shall be construed as subject always to all the provisions of the said Act and amendments thereof and all rules and regulations from time to time made thereunder.

Issued this 31st day of March, 1925.

File No. 106-4-16.

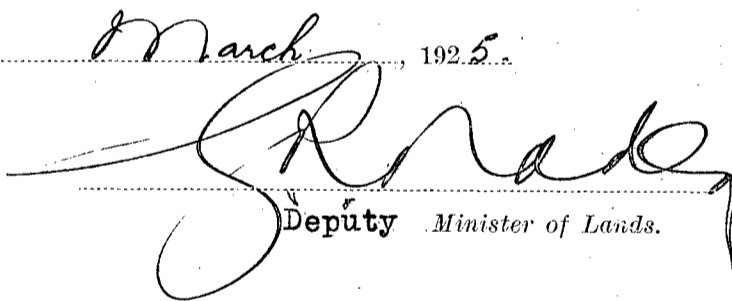

Deputy Minister of Lands.

British Columbia.

To accompany Permit for Right-of-way over Crown Land for Conditional Licence No. 3735

LILLOOET — WATER DISTRICT

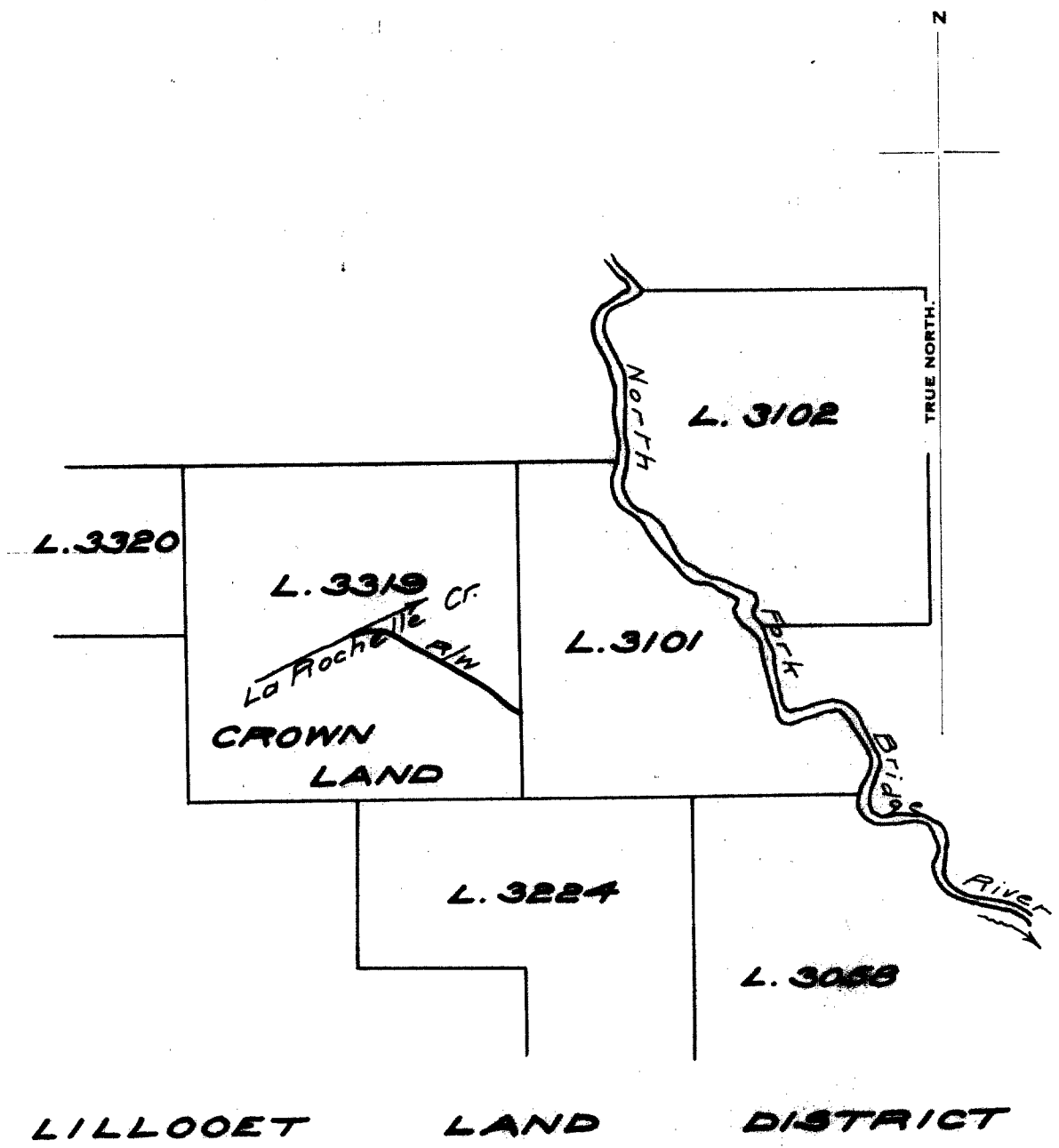
Scale, 20 Chains to 1 Inch.



LILLOOET LAND DISTRICT

Right-of-way across unoccupied CROWN LAND		
Length	Width	Area
1500 FT.	15 FT.	0.51 Ac.

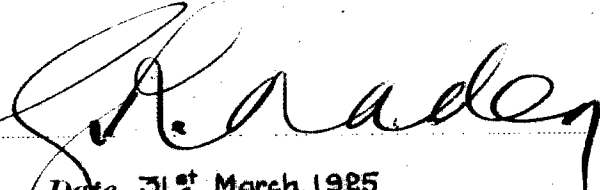
Signature 

Date 31st March 1925

R/W Permit for CL 3735
File 106-4-16

EXHIBIT "A"