



DEPARTMENT OF LANDS.

Permit under the "Water Act, 1939," authorizing the Occupation of Crown Land.

EMIL M. FALCK, of Van Winkle, B.C.,

the holder of a water licence authorizing the diversion of water from Kee Khan Creek is hereby authorized to occupy by constructing, maintaining and operating thereon the works authorized under amended Conditional Water Licence No. 11602,

vacant the following/Crown land, namely:—

a portion of the land lying between and adjoining Kee Khan Creek and the East Branch of Kee Khan Creek, Cariboo Land District, 2,900 feet in length and 15 feet in width, the location of which is shown approximately on the plan attached and marked "R/W", having an area of 1.00 acres.

And, subject to the payment of royalty and stumpage under the "Forest Act," is authorized to cut and remove from the said land any timber the removal of which is necessary to permit the construction of the said works.

There is payable in respect of this permit an annual rental of \$1.00, which is subject to alteration at any time. Failure to pay the annual rental will render this permit subject to cancellation.

This permit is appurtenant to the land to which the aforesaid water licence is appurtenant.

The conditions relative to the rights granted under this permit are printed on the back of this form.

Issued the 20th day of July, 1942.

[Signature] Deputy Minister of Lands.

File 0109733

Ref. W-R. Map 21 (B-1)

CONDITIONS RELATIVE TO THE RIGHTS GRANTED UNDER
THIS PERMIT.

1. This permit is issued under section 20 of the "Water Act, 1939," and the rights hereby granted are subject at all times to the provisions of that Act and all Acts passed in amendment or substitution thereof and to all regulations from time to time made under any such Act.
2. There is reserved to the Crown the right to grant to other persons permits to occupy the land affected by this permit without compensation to the permittee or his successors in title.
3. In the event of any dispute arising at any time between the permittee and any owner of land adjacent to the land affected by this permit with respect to the area or boundaries of the land so affected, the licensee shall at his own expense, when so directed by the Deputy Minister of Lands, have the said land surveyed by a duly qualified surveyor, and shall likewise file with the Department of Lands at Victoria, B.C., a plan showing the result of the survey.
4. This permit and the rights granted hereunder are subject always to compliance by the permittee with the terms of his water licence, and if the rights granted under the said licence should at any time be suspended or terminated the rights granted under this permit are thereupon likewise suspended or terminated.
5. The amount of royalty and stumpage payable by the permittee in respect of the timber cut or destroyed by him shall be the sum or sums fixed by the Forest Branch of the Government of British Columbia.

To accompany Conditional Licence No. UG02 as amended
and Permit for Right of Way over Crown Land
BARKERVILLE WATER DISTRICT.

Scale, 80 Chains to 1 Inch.

CARIBOO LAND DIST.

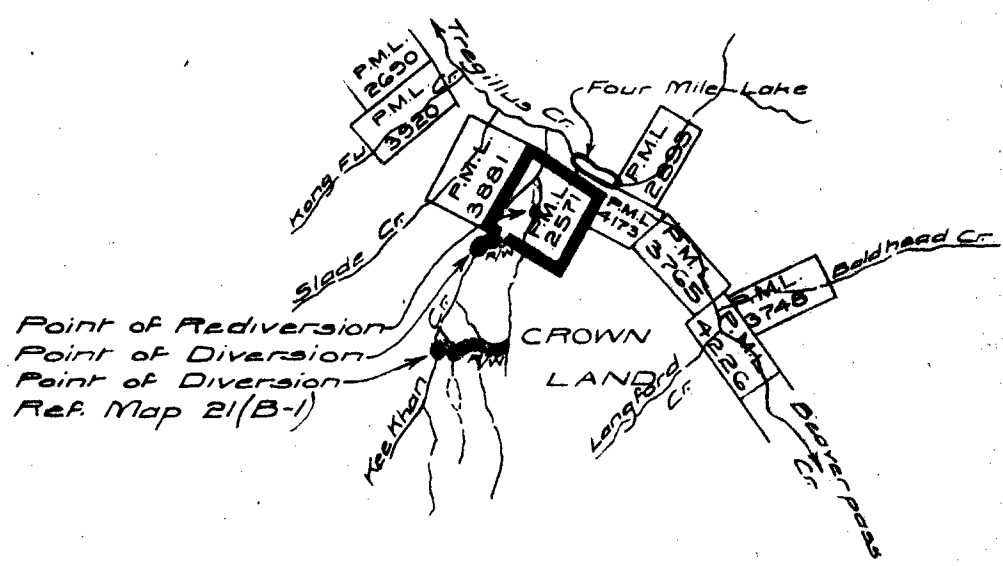

CARIBOO MINING DIV.

This Right of Way easement is issued subject to the rights of the holders of Placer Mining Leases issued prior to and in good standing on 19th Oct, 1932 and which may be affected by this R/W.

LEGEND

- Points of Diversion & Rediversion ○
- Ditch, Flume & Pipe ———
- Right of Way ———

The boundaries of the land to which this licence is appurtenant are shown thus: ———

Signature E. Davis

2212

Date 20th July 1932

EXHIBIT "A"

Amended CL
For R/W see Ref. Map 21(B-1)