



DEPARTMENT OF LANDS AND FORESTS

Permit under the "Water Act" Authorizing the Occupation of Crown Land

BRITISH COLUMBIA ELECTRIC COMPANY LIMITED, of Vancouver, B.C.

the holder of a water licence authorizing the storage of water in Wahleach (Jones) Lake is hereby authorized to occupy by flooding

the following Crown land, namely:—

those parts of Sections 7, 17, 18, 19, 20, 29 and 30, Township 3, Range 27, West 6th Meridian, lying below the 2,109 foot contour approximately as shown on Plan No. 3098BB, Water Rights Branch, more particularly shown on Exhibit "A" and marked "R/W" having an area of 373 acres.

And, subject to the payment of royalty, stumpage, and other compensation as provided under Condition 5, is authorized to destroy the timber on the said land by submerging it.

There is payable in respect of this permit an annual rental of \$37.30, which is subject to alteration at any time. Failure to pay the annual rental will render this permit subject to cancellation.

This permit is appurtenant to the land to which the aforesaid water licence is appurtenant.

The conditions relative to the rights granted under this permit are printed on the back of this form.

Issued the 8th day of August, 19 52

[Signature]

Deputy Minister of Lands.

File 5939W

W.R. Map 5841 and 5842

Ref. Map 86C-3

W.R.B. 12-1M-1051-9226

Superseded by PCL 18366 July 19, 1991

Conditional Licence No. 6409 PERMIT OVER CROWN LAND No. 3679

**CONDITIONS RELATIVE TO THE RIGHTS GRANTED
UNDER THIS PERMIT**

1. This permit is issued under section 20 of the "Water Act," and the rights hereby granted are subject at all times to the provisions of that Act and all Acts passed in amendment or substitution thereof and to all regulations from time to time made under any such Act.
2. There is reserved to the Crown the right to grant to other persons permits to occupy the land affected by this permit without compensation to the permittee or his successors in title.
3. In the event of any dispute arising at any time between the permittee and any owner of land adjacent to the land affected by this permit with respect to the area or boundaries of the land so affected, the licensee shall at his own expense, when so directed by the Deputy Minister of Lands, have the said land surveyed by a duly qualified surveyor, and shall likewise file with the Department of Lands and Forests at Victoria, B.C., a plan showing the result of the survey.
4. This permit and the rights granted hereunder are subjects-always to compliance by the permittee with the terms of his water licence, and if the rights granted under the said licence should at any time be suspended or terminated the rights granted under this permit are thereupon likewise suspended or terminated.
5. The amount of stumpage, royalty, and (or) compensation payable to the Crown by the permittee in respect of trees, including merchantable or young growth, cut, removed, damaged, or destroyed by the permittee, shall be the sum or sums fixed by the Forest Service of the Province of British Columbia.

British

Columbia



Copy

In accompany amended Conditional Licence G409
and Permit for Right of Way over Crown Land.

NEW WESTMINSTER WATER DISTRICT

Scale 80 Chains to 1 Inch

YALE DIVN OF YALE LAND DISTRICT

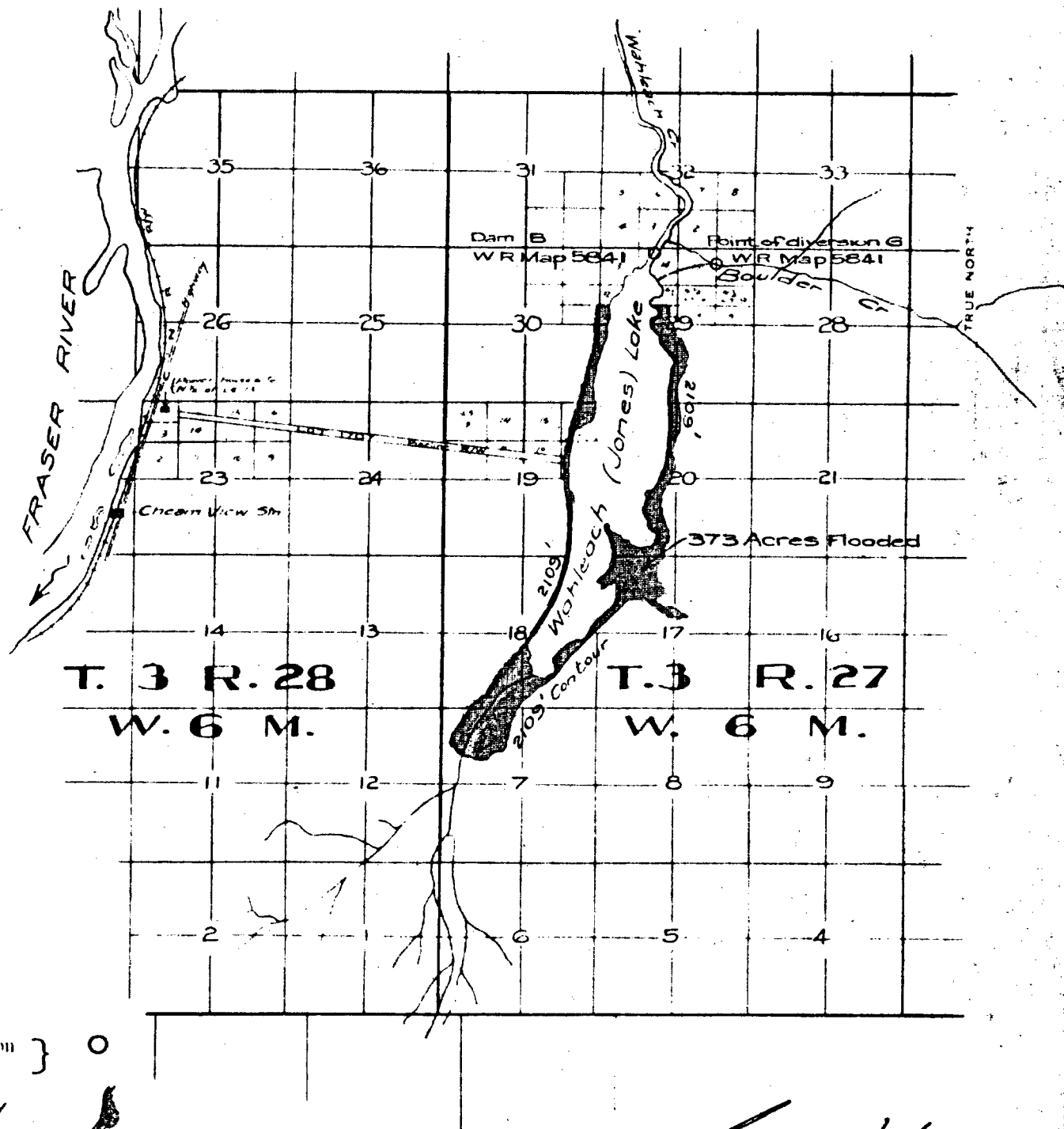

LEGEND

- Point of Diversion } ○
- Dam } [Symbol]
- Right of Way } [Symbol]

Signature *[Handwritten Signature]*

Date 8th August 1952

Amended (I. 6409
File 5939 W

EXHIBIT "A"

For R/W see Ref. Map 86 (C-3&4)

3679

4

British



Columbia

To accompany amended Conditional Licence 6409
and Permit for Right of Way over Crown Land.

NEW WESTMINSTER WATER DISTRICT

Scale: 80 Chains to 1 Inch

YALE DIV. OF YALE LAND DISTRICT

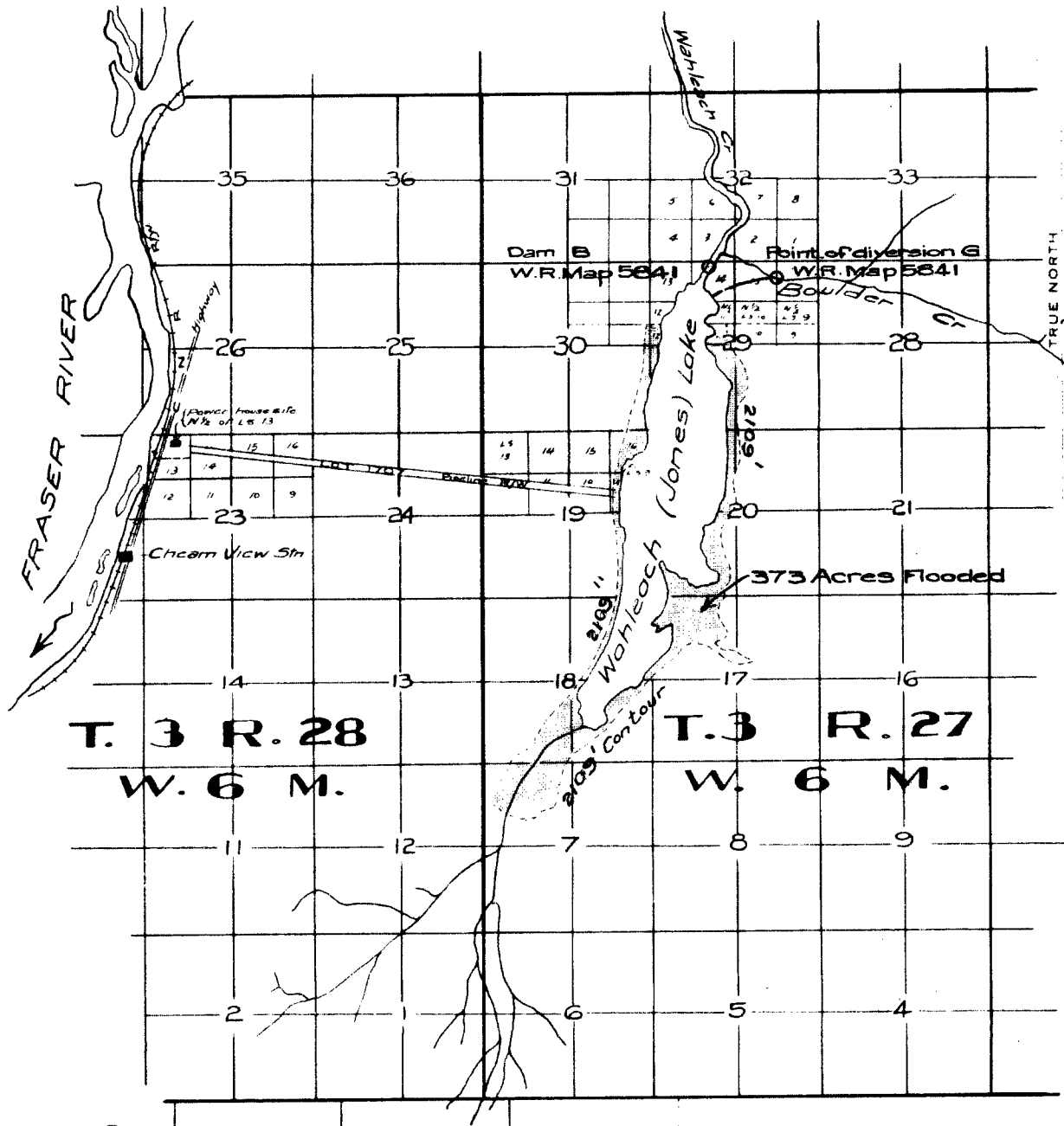

2

TRUE NORTH

LEGEND

- Point of Diversion } O
- Dam } [Symbol]
- Right of Way } [Symbol]

Signature *[Handwritten Signature]*

Date 8th August 1952

Amended C.L. 6409
File 5939 W

EXHIBIT "A"

For R/W see Ref. Map 86 (C-3&4)

3679