



THE GOVERNMENT OF  
THE PROVINCE OF BRITISH COLUMBIA

DEPARTMENT OF LANDS AND FORESTS

# Permit under the "Water Act" Authorizing the Occupation of Crown Land

Marvin H. Mayfield, of Box 67, Clinton, B.C.,

the holder of a water licence authorizing the diversion of water from Cutoff Valley Creek and Kay Creek

is hereby authorized to occupy by maintaining and operating thereon the works authorized

under Final Water Licences Nos: 7652 & 7624

the following Crown land, namely:— a portion of unsurveyed land lying between the South boundary of Lot 1059 and the East boundary of Lot 1060; between the East boundary of Lot 1060 and the West boundary of Lot 5072; between the South boundary of Lot 4428 and the West shore of Three Mile Lake; between the South boundary of Lot 5882 and the most southerly West boundary of Lot 4309; between the south boundary of Lot 4309 and the North boundary of Lot 4924; between three small lakes lying South of Lot 4924 and Lot 5883; across the most northerly angle corner of the East boundary of Lot 144, across the most Southerly angle corner of the West boundary of Lot 144 and between Kay Creek and part West boundary of Lot 144; all in Lillooet Land District, a portion of Lot 4924, Lillooet Land District, being 9700 feet in length and 15 feet in width, the location of which is shown approximately on the plan attached to the said water licence and marked "R/W".  
having an area of 3.34 acres.

And, subject to the payment of royalty, stumpage, and other compensation as provided under Condition 5,

is authorized to cut and remove from the said land any timber, the removal of which

is necessary to permit the construction of the said works.

There is payable in respect of this permit an annual rental of \$2.00, which is subject to alteration at any time. Failure to pay the annual rental will render this permit subject to cancellation.

This permit is appurtenant to the land to which the aforesaid water licence is appurtenant.

The conditions relative to the rights granted under this permit are printed on the back of this form.

Issued the 1st day of December, 1954.

*This permit  
replace permit  
1430*

*[Signature]*  
Deputy Minister of Lands.

File s Nos. 98-3A-7 and 018691

W.R. Map 331

Ref. Map \_\_\_\_\_

W.R.B. 12-1M-1053-6178

Conditional	Licence No. <u>7652</u>
Final	<u>7624</u>
PERMIT OVER CROWN LAND No. <u>3986</u>	

**CONDITIONS RELATIVE TO THE RIGHTS GRANTED  
UNDER THIS PERMIT**

1. This permit is issued under section 20 of the "Water Act," and the rights hereby granted are subject at all times to the provisions of that Act and all Acts passed in amendment or substitution thereof and to all regulations from time to time made under any such Act.
2. There is reserved to the Crown the right to grant to other persons permits to occupy the land affected by this permit without compensation to the permittee or his successors in title.
3. In the event of any dispute arising at any time between the permittee and any owner of land adjacent to the land affected by this permit with respect to the area or boundaries of the land so affected, the licensee shall at his own expense, when so directed by the Deputy Minister of Lands, have the said land surveyed by a duly qualified surveyor, and shall likewise file with the Department of Lands and Forests at Victoria, B.C., a plan showing the result of the survey.
4. This permit and the rights granted hereunder are subject always to compliance by the permittee with the terms of his water licence, and if the rights granted under the said licence should at any time be suspended or terminated the rights granted under this permit are thereupon likewise suspended or terminated.
5. The amount of stumpage, royalty, and (or) compensation payable to the Crown by the permittee in respect of trees, including merchantable or young growth, cut, removed, damaged, or destroyed by the permittee, shall be the sum or sums fixed by the Forest Service of the Province of British Columbia.

To accompany Permit for Right-of-way over Crown Land for Final Licence Nos 7624 & 7652

## ASHCROFT WATER DISTRICT

Scale, 80 Chains to 1 Inch.

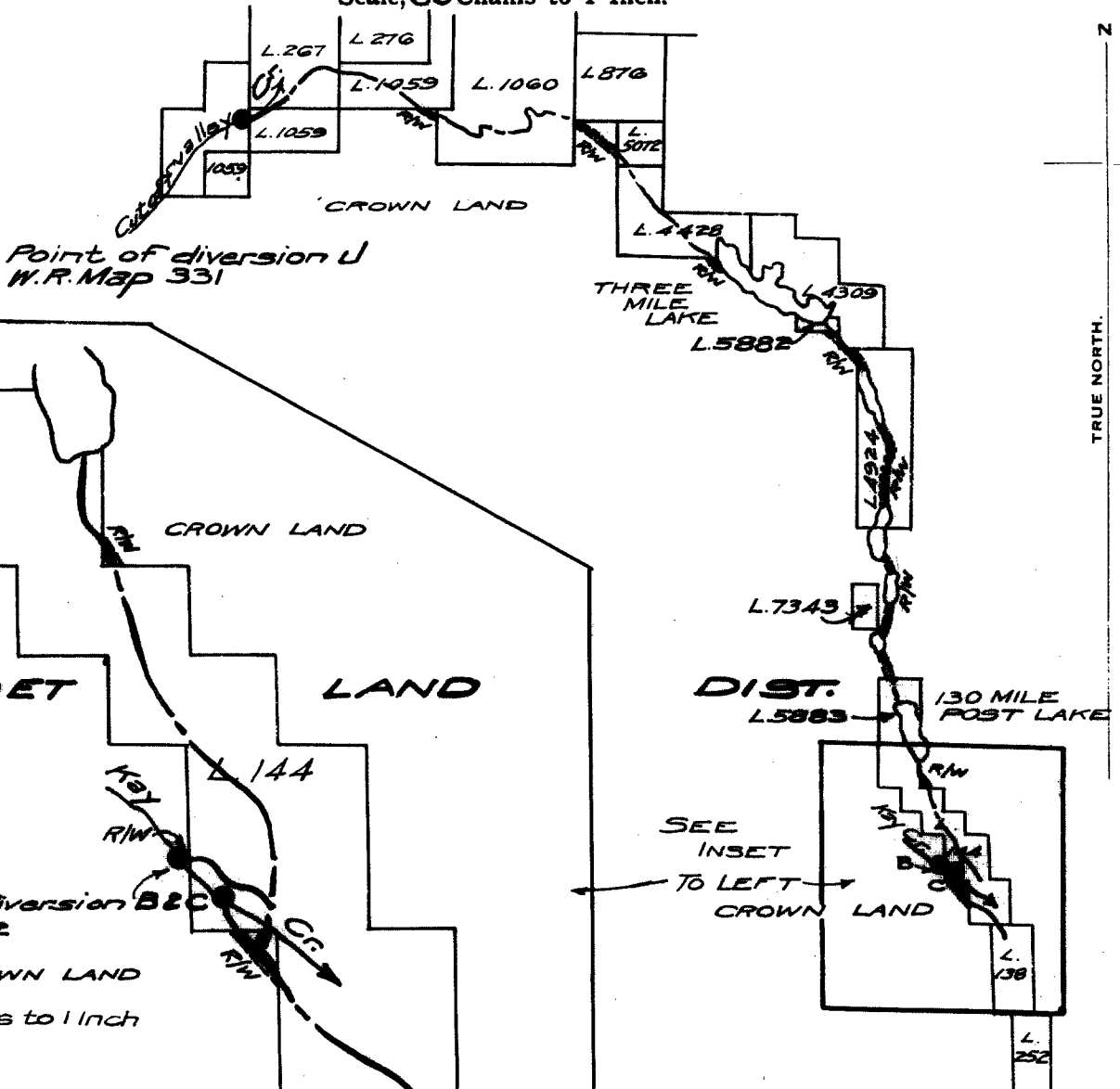

Points of diversion B & C  
W. R. Map 332

CROWN LAND

Scale: 20 Chains to 1 Inch

Right-of-way across unoccupied CROWN LAND		
Length	Width.	Area.
9700 FT.	15 FT.	3.34 Acres

**LEGEND**

Point of diversion ●

Ditch ————

Right of Way ————

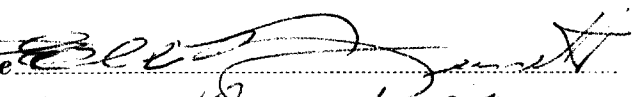
Signature 

Date Dec. 1st 1954

R/W Permit for F.L.s { 7624  
7652

Files { 98-3A-7  
018691

**EXHIBIT "A"**