



DEPARTMENT OF LANDS AND FORESTS

Permit under the "Water Act" Authorizing the Occupation of Crown Land

Donatus A. Cope, of R. R. #1, Louis Creek, B. C.,

the holder of x water licences authorizing the diversion of water from Homestake Creek and Sinmax Creek, is hereby authorized to occupy by constructing, maintaining and operating thereon the works authorized under the said water licences, and any licences which may be issued in substitution thereof,

the following Crown land, namely:— a portion of South West 1/4 of North East 1/4 Section 31, Township 24, Range 13, West 6th Meridian, and part of North West 1/4 Section 1, Township 25, Range 14, West 6th Meridian, being 2400 feet ± in length and 15 feet in width, the location of which is shown approximately on the attached plan and marked "Right-of-Way",

having a total area of 0.83 ± acres.

And, subject to the payment of royalty, stumpage, and other compensation as provided under Condition 5, is authorized to cut and remove from the said land any timber, the removal of which is necessary to permit the construction of the said works.

MRT

There is payable in respect of this permit an annual rental of \$1.00, which is subject to alteration at any time. Failure to pay the annual rental will render this permit subject to cancellation.

This permit is appurtenant to the land to which the aforesaid water licence is appurtenant.

The conditions relative to the rights granted under this permit are printed on the back of this form.

This Permit replaces Permit No. 4388.

Issued the 12th day of September, 19 60

R. J. [Signature] for c24278 Deputy Minister of Lands p.c. 9624

Files: 0114348 and 0217870
W.R. Map 3608 and 3609
Ref. Map 82 M/SW (A & B - 2)
W.R.B. 12-0

Replaced by PCL 14930

Conditional Final Licence No. 24278 4088
PERMIT OVER CROWN LAND No. 4738

**CONDITIONS RELATIVE TO THE RIGHTS GRANTED  
UNDER THIS PERMIT**

1. This permit is issued under section 20 of the "Water Act," and the rights hereby granted are subject at all times to the provisions of that Act and all Acts passed in amendment or substitution thereof and to all regulations from time to time made under any such Act.

2. There is reserved to the Crown the right to grant to other persons permits to occupy the land affected by this permit without compensation to the permittee or his successors in title.

3. In the event of any dispute arising at any time between the permittee and any owner of land adjacent to the land affected by this permit with respect to the area or boundaries of the land so affected, the licensee shall at his own expense, when so directed by the Deputy Minister of Lands, have the said land surveyed by a duly qualified surveyor, and shall likewise file with the Department of Lands and Forests at Victoria, B.C., a plan showing the result of the survey.

4. This permit and the rights granted hereunder are subject always to compliance by the permittee with the terms of his water licence, and if the rights granted under the said licence should at any time be suspended or terminated the rights granted under this permit are thereupon likewise suspended or terminated.

5. The amount of stumpage, royalty, and (or) compensation payable to the Crown by the permittee in respect of trees, including merchantable or young growth, cut, removed, damaged, or destroyed by the permittee, shall be the sum or sums fixed by the Forest Service of the Province of British Columbia.

10000

0852



*Handwritten initials/signature*

KAMLOOPS WATER DISTRICT  
KAMLOOPS DIVISION OF YALE DISTRICT

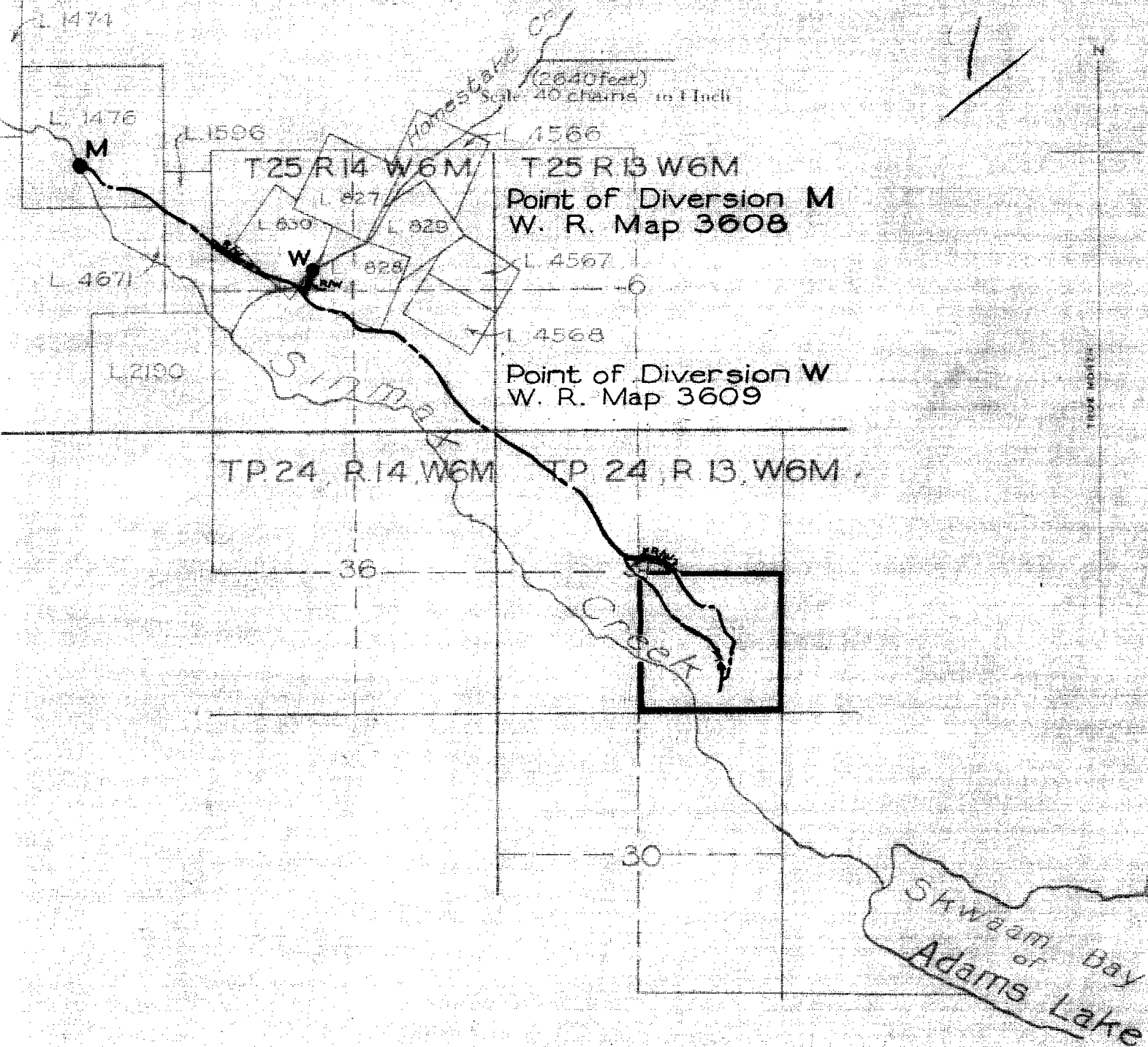

(2640 feet)  
Scale 40 chains to Inch

Point of Diversion M  
W. R. Map 3608

Point of Diversion W  
W. R. Map 3609

LEGEND

- Point of Diversion
- Ditch
- R/W

The boundaries of the land to which this license is limited are shown thus:

EXHIBIT "A"

Signature:

Date: 2 Sept, 1960  
R/W Permit No. 4756  
For CL24278 & FL14088  
Files 014348 & 0217870

For R/W see Ref. Map 82 M/sw (A-B-E)