



DEPARTMENT OF LANDS AND FORESTS  
AND WATER RESOURCES

Permit under the "Water Act" Authorizing the  
Occupation of Crown Land

Monte Lake Water Users' Community, of Westwold, B.C.

the holder of a water licence authorizing the diversion of water from Pringle and Monte Creeks

is hereby authorized to occupy by Constructing, maintaining and operating thereon the

works authorized under Final Water Licence Nos. 8113, 8128, 8130, 5949, 3846, 13826, 13850, 13851 and 13852, and any licences which may be issued in substitution thereof,

the following Crown land, namely:—

Occupied Crown land, part of Foreshore Lot 5476, Kamloops Division of Yale District, held under lease and land covered by water situated in Monte Lake, being 1800 feet ± in length and 20 feet in width, the location of which is approximately on the attached plan.

having an area of 0.82 ± acres.

~~AND SUBJECT TO THE PAYMENT OF RENTAL, SURVEY AND OTHER CONSIDERATION AS PROVIDED UNDER CONDITIONS~~

~~REQUIREMENTS~~

W.R.T.

There is payable in respect of this permit an annual rental of \$2.00, which is subject to alteration at any time. Failure to pay the annual rental will render this permit subject to cancellation.

This permit is appurtenant to the land to which the aforesaid water licence is appurtenant.

The conditions relative to the rights granted under this permit are printed on the back of this form.

Issued the 19th day of July, 1962.

*[Signature]*  
Deputy Minister of Lands.

File 0172610

W.R. Map 3735

Ref. Map 82L/SW(F-2)

W.R.B. 12-0

Conditional  
Final Licence No.s 8113, 8128,  
8130, 5949, 3846, 13826,  
13850, 13851 and 13852  
PERMIT OVER CROWN LAND No. 5058

**CONDITIONS RELATIVE TO THE RIGHTS GRANTED  
UNDER THIS PERMIT**

1. This permit is issued under section 23 of the "Water Act," and the rights hereby granted are subject at all times to the provisions of that Act and all Acts passed in amendment or substitution thereof and to all regulations from time to time made under any such Act.

2. There is reserved to the Crown the right to grant to other persons permits to occupy the land affected by this permit without compensation to the permittee or his successors in title.

3. In the event of any dispute arising at any time between the permittee and any owner of land adjacent to the land affected by this permit with respect to the area or boundaries of the land so affected, the licensee shall at his own expense, when so directed by the Deputy Minister of Lands, have the said land surveyed by a duly qualified surveyor, and shall likewise file with the Department of Lands and Forests at Victoria, B.C., a plan showing the result of the survey.

4. This permit and the rights granted hereunder are subject always to compliance by the permittee with the terms of his water licence, and if the rights granted under the said licence should at any time be suspended or terminated the rights granted under this permit are thereupon likewise suspended or terminated.

5. The amount of stumpage, royalty, and (or) compensation payable to the Crown by the permittee in respect of trees, including merchantable or young growth, cut, removed, damaged, or destroyed by the permittee, shall be the sum or sums fixed by the Forest Service of the Province of British Columbia.

British



Columbia

KAMLOOPS WATER DISTRICT  
KAMLOOPS DIVISION OF YALE DISTRICT

(20 Chains)  
Scale: 1320 Feet to 1 Inch



N

TRUE NORTH

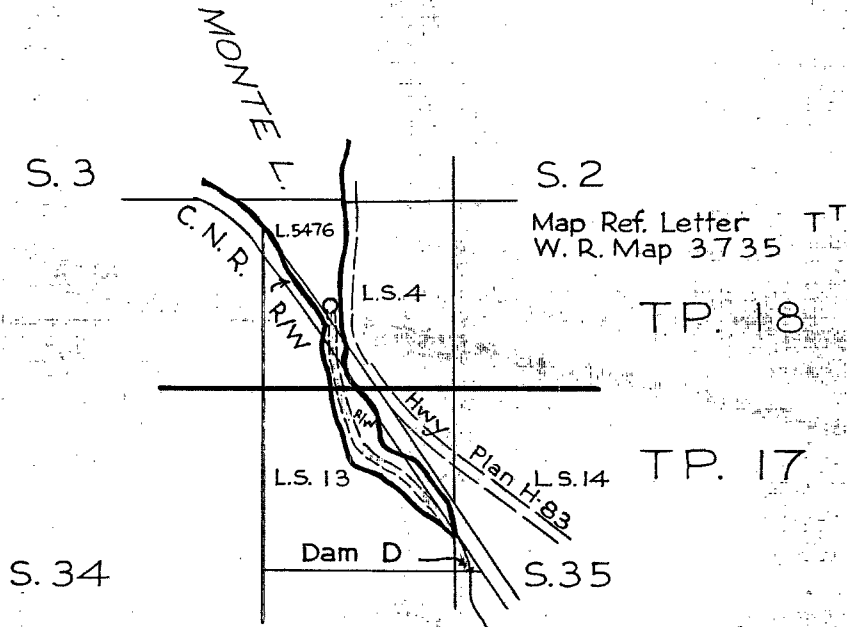
R. 14, W. 6 M.



LEGEND

Point of Diversion   
Channel   
Right of Way 

Signature *W. Rawdy*

Date *19 July, 1962*

EXHIBIT "A"

Amended F.L. 8113, 8128, 8130, 5949  
3846, 13825, 13826, 13851, 13850, 13852  
For R/W see Ref. Map 82 L/SW (F.2)

File 0172610  
R/W Permit 5058

British



Columbia

KAMLOOPS WATER DISTRICT  
KAMLOOPS DIVISION OF YALE DISTRICT

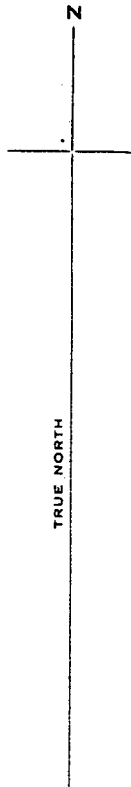

(20 Chains)  
Scale: 1320 Feet..... to 1 Inch.

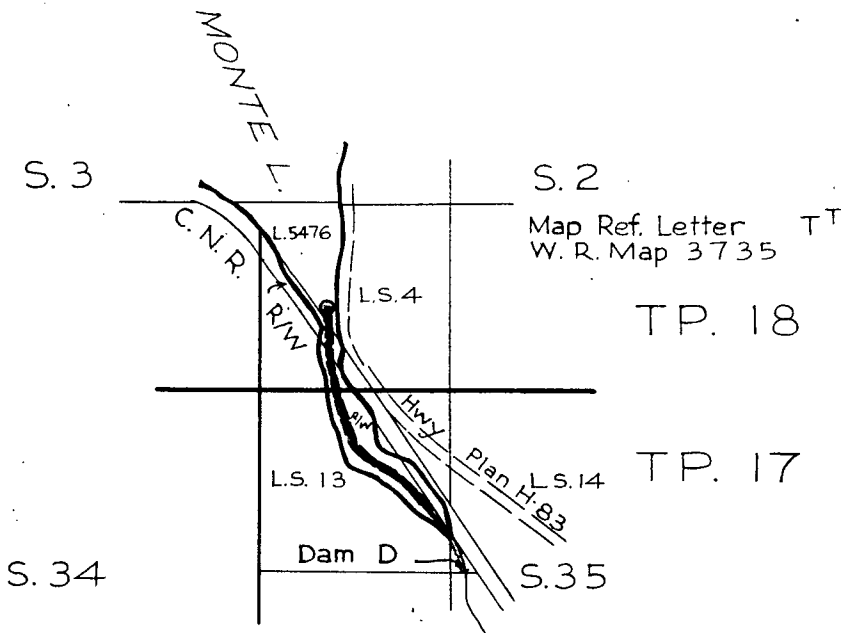

R. 14, W. 6 M.



LEGEND

- Point of Diversion 
- Channel 
- Right of Way 

Signature v. Raudyn

Date 19 July, 1962

EXHIBIT "A"

Amended F.L. 8113, 8128, 8130, 5949  
 3846, 13825, 13826, 13851, 13850, 13852  
 For R/W see Ref. Map 82 L/SW (F-2)

File 0172610  
 R/W Permit 5058