

CONDITIONS RELATIVE TO THE RIGHTS GRANTED UNDER THIS PERMIT

1. This permit is issued under the *Water Act*, and the rights hereby granted are subject at all times to the provisions of that Act and all Acts passed in amendment or substitution thereof and to all regulations from time to time made under any such Act.

2. There is reserved to the Crown the right to grant to other persons permits to occupy the land affected by this permit without compensation to the permittee or his successors in title.

3. In the event of any dispute arising at any time between the permittee and any owner of land adjacent to the land affected by this permit with respect to the area or boundaries of the land so affected, the licensee shall at his own expense, when so directed by the Deputy Minister of the Environment, have the said land surveyed by a duly qualified surveyor, and shall likewise file with the Ministry of the Environment at Victoria, British Columbia, a plan showing the result of the survey.

4. This permit and the rights granted hereunder are subject always to compliance by the permittee with the terms of his water licence, and if the rights granted under the said licence should at any time be suspended or terminated, the rights granted under this permit are thereupon likewise suspended or terminated.

5. The amount of stumpage, royalty, and (or) compensation payable to the Crown by the permittee in respect of trees, including merchantable or young growth, cut, removed, damaged, or destroyed by the permittee, shall be the sum or sums fixed by the Forest Service of the Province of British Columbia. Prior to the cutting, destruction, or flooding of any timber, the permittee must apply for and obtain a licence to cut timber from the District Forester.

British



Columbia

PRINCE GEORGE WATER DISTRICT

PEACE RIVER DISTRICT

Scale: 80 Chains to 1 Inch

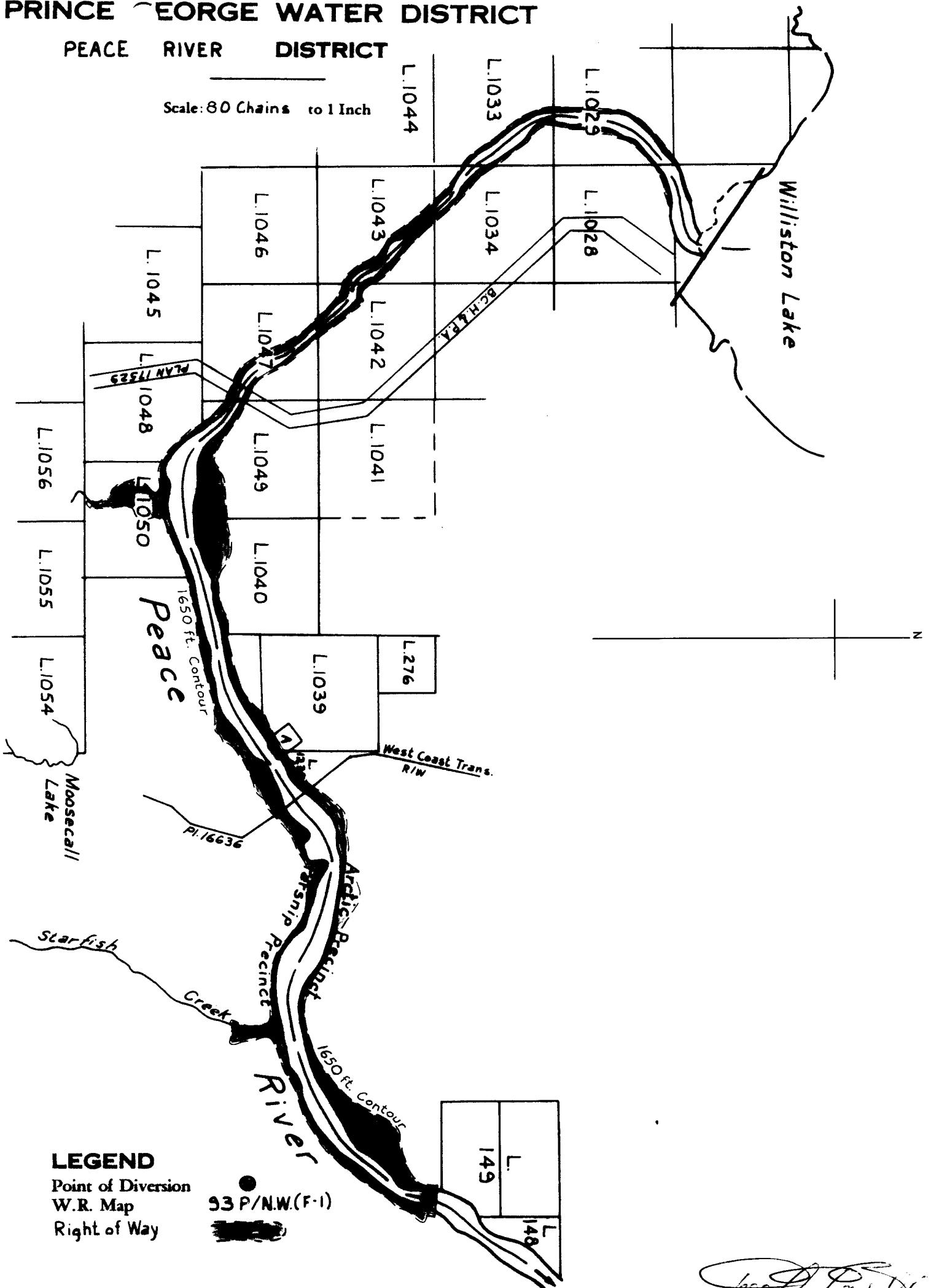

LEGEND

- Point of Diversion
- W.R. Map
- Right of Way

93 P/N.W.(F-1)

Signature

Date 9th Nov. 1979.
 P.C.L.12187 for C.L. 42203
 File 0322380