



PERMIT UNDER THE WATER ACT AUTHORIZING THE OCCUPATION OF CROWN LAND

The holders of Conditional Water Licences 67495 and 64848, whose licences authorize the diversion of water from Rhymeley and Wyandotte Creeks, are hereby authorized to occupy Crown Land by constructing, maintaining and operating thereon the works authorized under the said licences.

- (a) The Crown Land which is authorized to be occupied under this permit is a portion of Lot 7623 and unsurveyed land, Kootenay District, the location of which is shown approximately on the plan attached.
- (b) The approximate area of the Crown Land authorized to be occupied under this permit is 1.89 acres, being 5,500 feet in length and 15 feet in width, for a pipeline.
- (c) The permittee may cut and remove from the said Crown Land any timber necessary to permit construction and maintenance of the said works. Prior to the cutting, destruction or flooding of any timber, the permittee shall apply for and obtain a licence to cut timber from the District Manager and the amount of stumpage, royalty and (or) compensation payable to the Crown in respect of trees, including merchantable or young growth, cut, removed, damaged, or destroyed by the permittee, shall be the sum or sums fixed by the Forest Service of the Province of British Columbia.
- (d) This permit is appurtenant to the land, mine or undertaking to which the aforesaid water licences are appurtenant.
- (e) This permit shall become void if the water licences with respect to which the permit is issued should terminate, be abandoned or cancelled, or amended so as to render this permit unnecessary.
- (f) This permit is issued and accepted on the understanding that the permittee shall indemnify and save harmless the Government of the Province of British Columbia for all loss, damage to works, cost or expense suffered by the permittee by reason of the Crown Land or any portion thereof being submerged or damaged by erosion or otherwise affected by flooding.
- (g) The holder of this permit shall not be entitled to compensation if the Crown grants permits to other persons to occupy the land affected by this permit.
- (h) In the event of a dispute at any time with respect to the area or boundaries of the land affected by this permit, the holder shall, at his own expense, have the said land surveyed by a duly qualified surveyor.
- (i) The annual rental for this permit is \$5.00, which is subject to review and revision at any time at the discretion of the Crown.
- (j) This permit replaces Permits No. 16670 and 16190.

E. D. Anthony
Acting Deputy Minister of Environment

001



Province of British Columbia

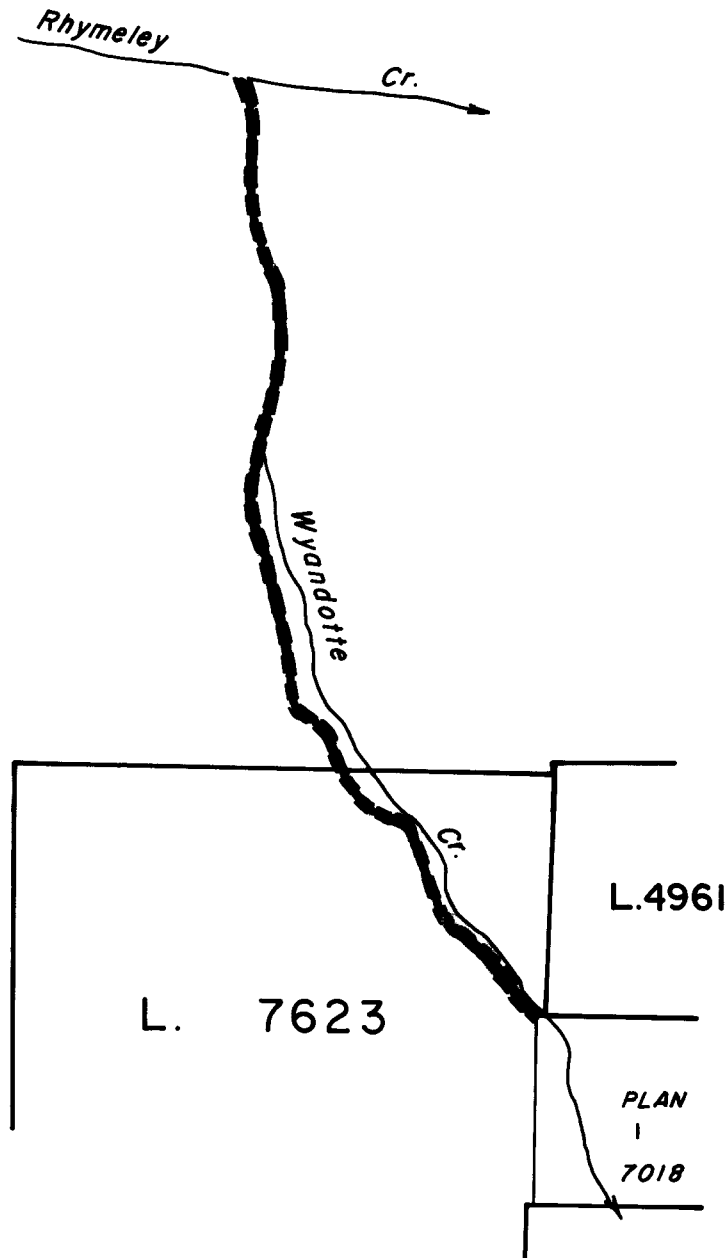

WATER DISTRICT : NELSON
 PRECINCT : PROCTER
 LAND DISTRICT : KOOTENAY

Signature

Date

LEGEND

Scale : 1000 Feet to 1 Inch

P.C.L. 17217

for P.C.L. 16670 & 16190

File 0223658, 0364893

Map Number : W R 82 F/ NE (10-e), W.R. 5251A

Permit over Crown Land: