



PERMIT UNDER THE WATER ACT AUTHORIZING THE OCCUPATION OF CROWN LAND

The holder of Conditional Licence 65259, and any licence issued in substitution thereof, whose licence authorizes the diversion of water from Chapman Creek, is hereby authorized to occupy Crown Land by constructing, maintaining and operating thereon the works authorized under the said licence and any licence which may be issued in substitution thereof.

- (a) The Crown Land which is authorized to be occupied under this permit is a portion of Blocks A and B of District Lot 2725, New Westminster District.
- (b) The approximate dimensions of the Crown Land authorized to be occupied under this permit are:-
- | | |
|----------------------------------|---------------|
| Pipeline: 7450 feet by 30 feet = | 5.13 acres |
| Reservoir: 455,00 square feet = | 10.33 acres |
| TOTAL | = 15.46 acres |
- (c) The permittee may cut and remove from the said Crown Land any timber necessary to permit construction and maintenance of the said works. Prior to the cutting, destruction or flooding of any timber, the permittee shall apply for and obtain a licence to cut timber from the District Manager and the amount of stumpage, royalty and (or) compensation payable to the Crown in respect of trees, including merchantable or young growth, cut, removed, damaged, or destroyed by the permittee, shall be the sum or sums fixed by the Forest Service of the Province of British Columbia.
- (d) This permit is appurtenant to the land, mine or undertaking to which the aforesaid water licence is appurtenant.
- (e) This permit shall become void if the water licence with respect to which the permit is issued should terminate, be abandoned or cancelled, or amended so as to render this permit unnecessary.
- (f) This permit is issued and accepted on the understanding that the permittee shall indemnify and save harmless the Government of the Province of British Columbia for all loss, damage to works, cost or expense suffered by the permittee by reason of the Crown Land or any portion thereof being submerged or damaged by erosion or otherwise affected by flooding.
- (g) The holder of this permit shall not be entitled to compensation if the Crown grants permits to other persons to occupy the land affected by this permit.
- (h) In the event of a dispute at any time with respect to the area or boundaries of the land affected by this permit, the holder shall, at his own expense, have the said land surveyed by a duly qualified surveyor.
- (i) The annual rental for this permit is \$20.20, which is subject to review and revision at any time at the discretion of the Crown.

J. W. McCracken, P. Eng.
Regional Water Manager
duly authorized designate of
the Minister of Environment



Province of British Columbia

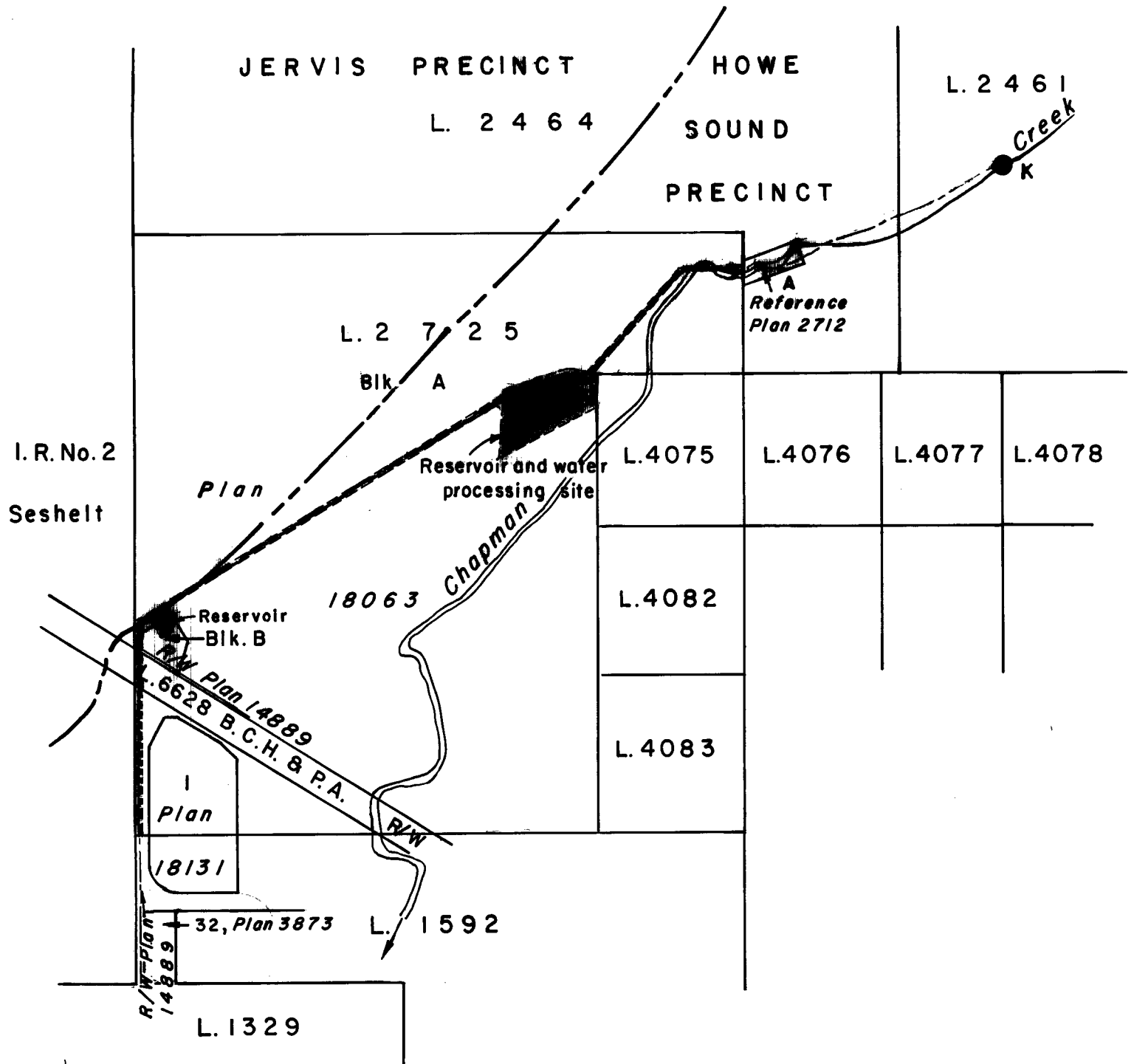

WATER DISTRICT : VANCOUVER
 PRECINCT : HOWE SOUND
 LAND DISTRICT : G.P.I, NEW WESTMINSTER

Signature *Jw Mc Craiken*
 Date 31st. March, 1989.

LEGEND

Scale : 1:15,000
 Point of Diversion : ●
 Map Number : WR92 G-042-3-4
 Pipe : ————
 Permit over Crown Land: ■■■■■■ ■■■■■■

Amended C.L.65259
 File 0309244
 P.C.L.17348
 For storage see C.L.50724

This licence is appurtenant to all the lands within the boundaries of The Sunshine Coast Regional District.