



Province of
British Columbia

Ministry of
Environment,
Lands and Parks

BC
Environment

Water Management Division
765 Broughton Street
Victoria
British Columbia
V8V 1X4

September 17, 1993

File: 0265200

BC HYDRO AND POWER AUTHORITY
PROPERTY TAX SECTION
11TH FLOOR-333 DUNSMUIR ST
VANCOUVER BC V6B 5R3

Dear Sir/Madam:

**Re: Conditional Water Licence 9264 - Carpenter Lake
Permits under the Water Act authorizing
the occupation of Crown Land**

Crown Land Permits numbers 3082, 3228 and 4590 were issued in connection with Conditional Water Licence 9264 to authorize the occupation of Crown land for construction, maintaining and operating thereon the works authorized under the said water licences.

For administrative record keeping purposes, the rights authorized by the above noted Permit numbers have been combined and renumbered as a single Permit authorizing the occupation of Crown land.

Permit numbers 3082, 3228 and 4590 have now been combined and renumbered as Permit number 20862.

If you have any questions, please feel free to contact this office.

Yours truly,

Chris Morgan
A/Head
Water Licence Administration

cc: Southern Interior Region - Kamloops

Indian and Northern Affairs Canada, 300-1550 Alberni St., Vancouver,
BC V6G 3C5

Seton Lake Indian Band, 987-595-8151, General Delivery, Shalalth, BC
V0N 3C0

C.L. 0264



DEPARTMENT OF LANDS AND FORESTS.

Permit under the "Water Act, 1939," authorizing the Occupation of Crown Land.

BRITISH COLUMBIA ELECTRIC COMPANY LTD. , of Vancouver, B.C.,

the holder of a water licence authorizing the diversion of water from Bridge River, is hereby authorized to occupy by constructing, maintaining and operating thereon the works authorized under the said water licence and any licence which may be issued in substitution thereof.

the following Crown land, namely:—

the bed of Bridge River and Mel No. 2 and Iris No. 1 Mineral Claims Lillooet Mining Division, lying within expired S.T.L. 5075^P and the land lying north of S.T.L. 5075^P, Lillooet Land District, being 3,200' in length and 100' in width, the location of which is shown approximately on the attached plan and marked "R/W"

having an area of 9.33 acres.

And, subject to the payment of royalty and stumpage under the "Forest Act" is authorized to cut and remove from the said land any timber, the removal of which is necessary to permit the construction of the said works.

There is payable in respect of this permit an annual rental of \$4.50, which is subject to alteration at any time. Failure to pay the annual rental will render this permit subject to cancellation.

This permit is appurtenant to the land to which the aforesaid water licence is appurtenant.

The conditions relative to the rights granted under this permit are printed on the back of this form.

Issued the 19th day of June, 1948.

[Signature]
Acting Deputy Minister of Lands and Forests

File 0115227

W.R. Map

Ref. Map 24a (D-2) and Min. Ref. Map 21 T 269

#3082

British  Columbia

Permit for R/W over Crown Land
To accompany Conditional Licence No. 9264.....

LILLOOET WATER DISTRICT

Scale: 1500 Ft. to 1 Inch.

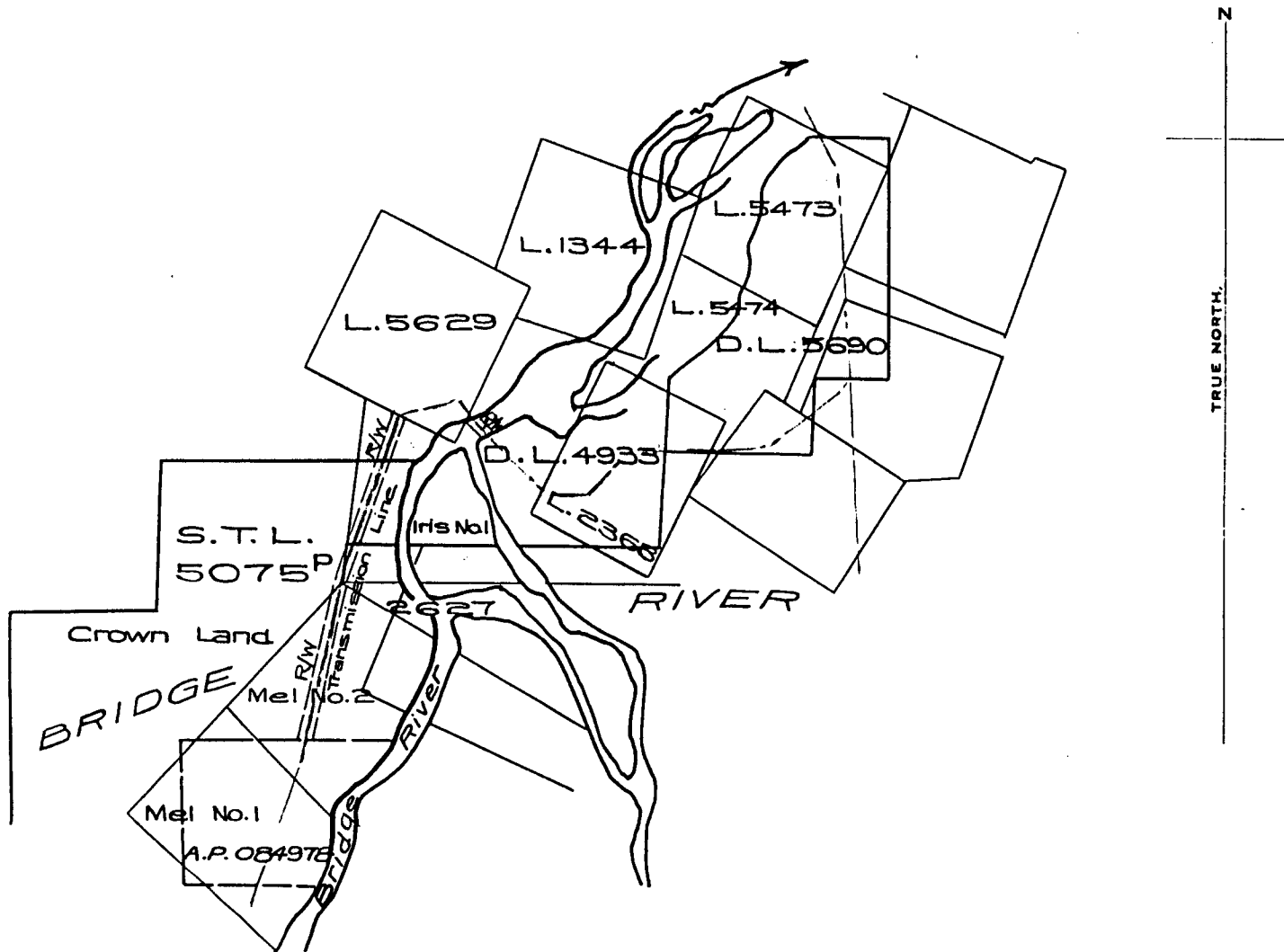

LILLOOET LAND DISTRICT
LILLOOET MINING DIVISION

LEGEND.

Transmission Line 
R/W 

EXHIBIT "A"

100-345-5607

Signature 

Date 19 June 1948

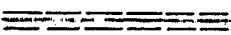
R/W for C.L. 9264
File 0115227

For R/W See Ref. Map 24A (D-2)
& Mineral Ref. Map 21 T 269

3082



DEPARTMENT OF LANDS AND FORESTS

Permit under the "Water Act, ~~1933~~" authorizing the
Occupation of Crown Land

BRITISH COLUMBIA ELECTRIC COMPANY LIMITED, of Vancouver, B.C.

the holder of a water licence authorizing the diversion of water from Bridge River
is hereby authorized to occupy by maintaining and operating thereon the works authorized
under Conditional Water Licences Nos. 9264 and 18539.

the following Crown land, namely:—

portions of Lots 5917 (Lodge B), 5509 (Cabinet), 5510 (Counsel), 5628 (Counsel No. 2)
1342 (Hillside Fractional) and 1341 (Hillside No. 4), being 6500 feet in length and

100 feet in width, the location of which is shown approximately on the attached
plan and marked "R/W"
having an area of 15 acres.

And, subject to the payment of royalty and stumpage under the "Forest Act" is authorized to
cut and remove from the said land any timber the removal of which is necessary to
permit the construction of the said works.

There is payable in respect of this permit an annual rental of \$7.50, which is subject
to alteration at any time. Failure to pay the annual rental will render this permit subject to
cancellation.

This permit is appurtenant to the land to which the aforesaid water licence is appurtenant.

The conditions relative to the rights granted under this permit are printed on the back of this
form.

Issued the 18th day of May, 1949

Deputy Minister of Lands.

File 4899W

W.R. Map 4513

Ref. Map 24 (E-2) and Min. Ref. Map 2T269

W.R.B. 12-1M-648-3051

3228

British Columbia



To accompany Conditional Licence No. 9264 & 18539
And Permit for R/W Over Crown Land

LILLOOET WATER DISTRICT

Scale: 1500 Feet to 1 Inch.

LILLOOET LAND DISTRICT

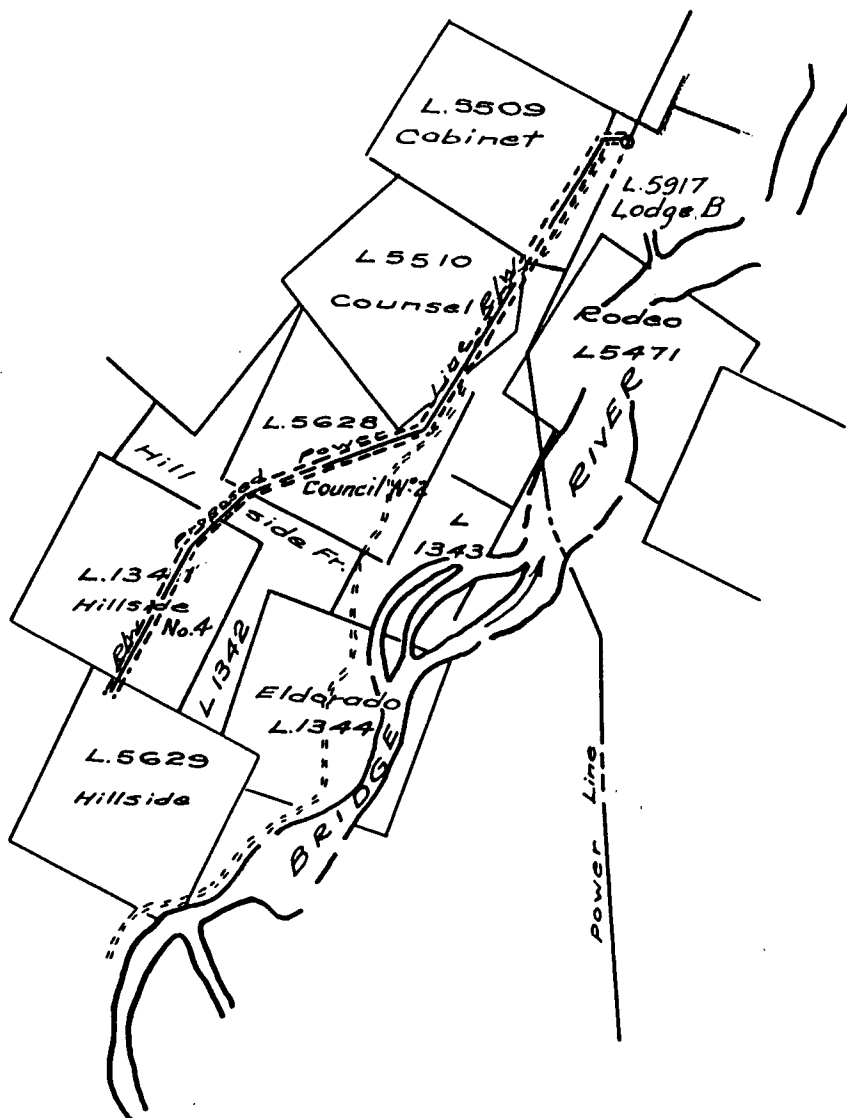

LILLOOET MINING DIVISION

LEGEND.

Point of Diversion ○

Powerline ———

Right-of-Way =====

The boundaries of the land to which this licence is appurtenant are shown thus; **—————**

EXHIBIT "A"

100-345-5607 W.E.M. 4513

For R/W See Ref Map 24(E-2)
Min Ref Map 2 T 269

Date 18 May 1949

3228

C.L. 18539
File 4899

J. E. Lane



DEPARTMENT OF LANDS AND FORESTS

Permit under the "Water Act" Authorizing the Occupation of Crown Land

British Columbia Electric Company Limited, of 970 Burrard Street, Vancouver 1, B. C.

the holder of x water licence authorizing the diversion of water from Bridge River is hereby authorized to occupy by constructing, maintaining and operating thereon the works authorized under the said water licences and any licences which may be issued in substitution thereof the following Crown land, namely:—

Access road right-of-way crossing unsurveyed vacant Crown land and parts of Surveyed Timber Leases 8219P and 8220P, Group 1, New Westminster District, being 8000 feet in length and 30 feet in width, the location of which is shown approximately on the attached plan having an area of 5.5 acres.

And, subject to the payment of royalty, stumpage, and other compensation as provided under Condition 5, is authorized to cut and remove from the said lands, any timber, the removal of which is necessary to permit the construction of the said works.

There is payable in respect of this permit an annual rental of \$3.00, which is subject to alteration at any time. Failure to pay the annual rental will render this permit subject to cancellation.

This permit is appurtenant to the land to which the aforesaid water licence is appurtenant.

The conditions relative to the rights granted under this permit are printed on the back of this form.

Issued the 13th day of January, 1960.

Deputy Minister of Lands.

File s. 4899W #3 - 0202694 - 0210947

W.R. Map

Ref. Map 92J/SE (EG-1)

W.R.B. 12-o

Conditional Licence Nos. 9264-22129 23626 PERMIT OVER CROWN LAND No. 1590

British



Columbia

To accompany Permit for Right of way over Crown Land for Conditional Licence Nos.

LILLOOET WATER DISTRICT

Scale: 1500 Feet to 1 Inch

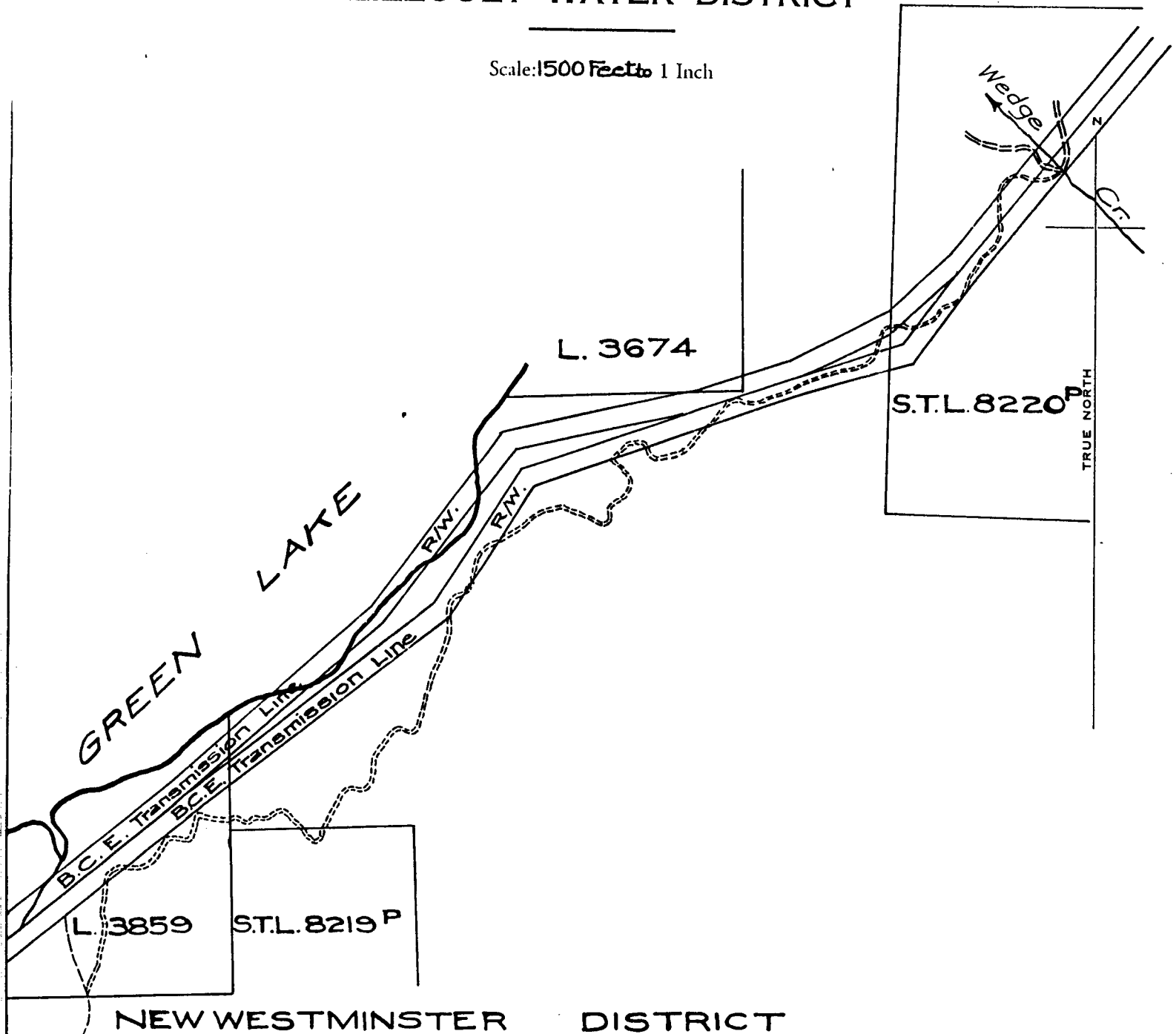

Right of way across CROWN LAND		
Length	Width	Area
8000 Feet	30 Feet	5.5 Acres.

EXHIBIT "A"

edk

100-1049-4201

Ref. Map 92 1/2 SE. (B.C.-1)

Signature.....

[Handwritten Signature]

Date.....

13 Jan. 1960

R/W Permit for CL's & 23626

Files 4899W #3

0202694

0210947

Permit No. 4590