

MINISTRY OF ENVIRONMENT, LANDS AND PARKS
WATER MANAGEMENT BRANCH
PROVINCE OF BRITISH COLUMBIA

**PERMIT UNDER THE WATER ACT AUTHORIZING
THE OCCUPATION OF CROWN LAND**

The holder of Conditional Water Licence 47208, whose licence authorizes the diversion of water from Mollice Lake, is hereby authorized to occupy Crown Land by constructing, maintaining and operating thereon the works authorized under the said licence and any licence which may be issued in substitution thereof.

- (a) The Crown land which is authorized to be occupied under this permit is a portion of District Lot 838, Range 4, Coast District, the location of which is shown approximately on the plan attached to the said water licence.
- (b) The approximate dimensions of the Crown Land authorized to be occupied under this permit are 660 feet in length, 15 feet in width and having an area of 0.23 acres.
- (c) The permittee may cut and remove from the said Crown Land any timber necessary to permit construction and maintenance of the said works. Prior to the cutting, destruction or flooding of any timber, the permittee shall apply for and obtain a licence to cut timber from the District Manager and the amount of stumpage, royalty and (or) compensation payable to the Crown in respect of trees, including merchantable or young growth, cut, removed, damaged, or destroyed by the permittee, shall be the sum or sums fixed by the Forest Service of the Province of British Columbia.
- (d) This permit is appurtenant to the land, mine or undertaking to which the aforesaid water licence is appurtenant.
- (e) This permit shall become void if the water licence with respect to which the permit is issued should terminate, be abandoned or cancelled, or amended so as to render this permit unnecessary.
- (f) This permit is issued and accepted on the understanding that the permittee shall indemnify and save harmless the Government of the Province of British Columbia for all loss, damage to works, cost or expense suffered by the permittee by reason of the Crown Land or any portion thereof being submerged or damaged by erosion or otherwise affected by flooding.
- (g) The holder of this permit shall not be entitled to compensation if the Crown grants permits to other persons to occupy the land affected by this permit.
- (h) In the event of a dispute at any time with respect to the area or boundaries of the land affected by this permit, the holder shall, at his own expense, have the said land surveyed by a duly qualified surveyor.



W.H. Dreher, P. Eng.
Regional Water Manager
pduly authorized representative of the
Minister of Environment, Lands & Parks



Province of British Columbia

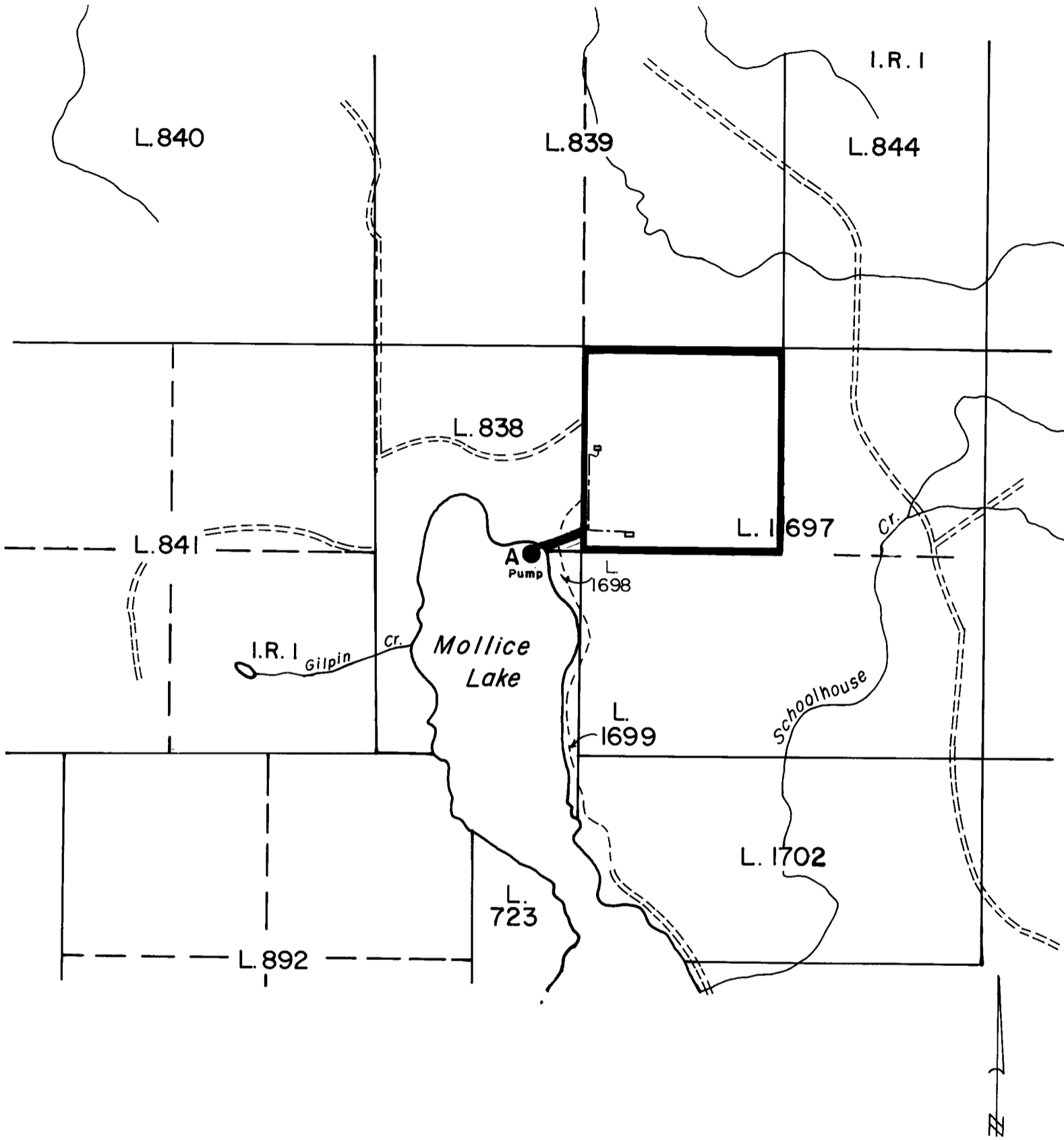

WATER DISTRICT : HAZELTON
 PRECINCT : BURNS LAKE
 LAND DISTRICT : RANGE 4 , COAST

LEGEND

Scale : 1 : 20,000
 Point of Diversion : ●
 Map Number : WR 93. F. 092
 Pipe : ————
 Permit over Crown Land: =====

Signature *Wheeler*
 Date : JAN 17 1905

C.L. 47208
 File 0328863
 P.C.L. 21050

The boundaries of the land to which this licence is appurtenant are shown thus: **—————**